

Portable mini disc recorder

operating instructions

Basic version	Page 13
Advanced version	Page 26
When in trouble • Q & A	Page 75

Thank you for your purchase.



Failure to follow safety precautions for electrical products can result in fire or personal injury.

This instruction manual describes important precautions to prevent accidents and how to handle the product. Please read this instruction manual carefully before using the product safely. After reading it, be sure to keep it in a place where you can see it at any time.



MZ-N920



For your safety

Sony products are designed with due consideration for safety. However, if all electrical products are used improperly, they may cause personal injury due to fire or electric shock, which is dangerous. Be sure to observe the following to prevent accidents.



Observe safety precautions

Please read the notes on pages 8-12 carefully. Contains general precautions for the product.

Check regularly

Once a year, check that there is no dust accumulated between the plug of the AC power adapter and the concept, and that the product is not used with a malfunction.

Do not use if it breaks down

If you notice any malfunction or damage to the AC power adapter, charging stand, etc., immediately contact the store where you purchased the product or a Sony service representative for repair.

Should something go wrong

If you hear strange sounds or smells, or if smoke comes out



b b

- 1 Turn off the power
- 2 Unplug the AC power adapter from the outlet / dedicated from the computer
- Unplug the USB cable 3
- Request repair from the store where you purchased the product or the Sony service counter.

Meaning of warning

display The following is displayed in the instruction manual and the product. Please read the text after fully understanding the contents of the display.



Failure to follow the precautions on this label may result in death or serious injury due to fire, electric shock, explosion, etc.



Failure to follow the precautions on this label may result in personal injury such as death or serious injury due to fire or electric shock.

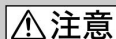

Failure to follow the precautions on this label may result in injury or damage to nearby household items due to electric shock or other causes.

Attention symbol



火災



感電

Symbol prohibiting acts



禁止



接触禁止



ぬれ手禁止



分解禁止

Symbols that indicate actions



強制

About self-regulation of radio

interference This device is a class B information technology device based on the standards of the Voluntary Control Council for Radio Interference (VCCI) such as information processing equipment . Although this device is intended for use in a home environment, it may cause reception problems if used in close proximity to radio or television receivers. Please handle it correctly according to the instruction manual.

- If you cannot record or download due to a malfunction of this product or your computer, or if the music data is damaged or deleted, please forgive us for compensation for the contents of the data.
- For recordings that cannot be re-recorded, be sure to make a trial recording in advance. • What you record cannot be used without the permission of the copyright holder under copyright law, except for personal enjoyment. The price of this product includes private copying levy according to the copyright law. (Contact: Private Copy Levy Management Association Tel.03-5353-0336)

- "Walkman" and "WALKMAN" are Sony Corporation's headphone stereo products.

It is a registered trademark.



Is a registered trademark of Sony Corporation.

- SonicStage, MD Simple Burner, OpenMG, Net MD and their respective logos
Is a trademark of Sony Corporation.

What you can do with this machine and the attached manual

This page explains what you can do with a portable MD recorder and the manual. Please refer to the following and use the required manual.

When using this machine

You can connect a CD player or microphone to the main unit to record, and play back what you have recorded to enjoy.

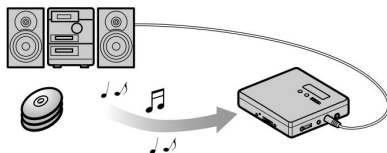

Instruction manual (this manual)

Explains the overall operation of this machine. It also describes what to do if a problem occurs or a message is displayed while operating this unit.

If you have a problem or want to know **more**

Please refer to "Troubleshooting" (page 75) and "MD Knowledge Q & A" (from page 87) in the instruction manual (this manual) .

When using the included software on your computer

You can use the software SonicStage / MD Simple Burner that comes with this unit to transfer music data between the main unit and your computer.

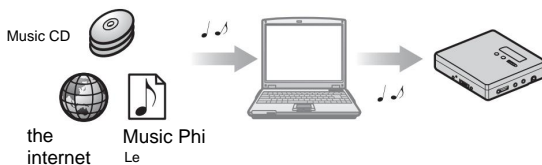

Installation / Operation Guide

SonicStage Ver.2.0 Explains how to use the software (SonicStage Ver.2.0 / MD Simple Burner Ver.2.0) that comes with MD **Simple Burner Ver.2.0 for MD Walkman** .





SonicStage Ver.2.0 Help

This is the manual you see on your computer screen. It explains how to use the attached software SonicStage Ver.2.0 in more detail than the "Installation / Operation Guide". also, If you have any problems while using SonicStage Ver.2.0, please see here.



Personal audio customer support

It is a homepage on the Internet. You can see the latest support information for this machine and the attached software.

 警告  注意	8
---	---

Basic edition

prepare

Check the accessories	13
Names of each part	14

Basic usage

prepare	18 18
----------------------	-------

Record	twenty one
---------------------	------------

Reproduce	twenty four
------------------------	-------------

Advanced version

Before starting the operation

How to operate the menu	26
Menu list	27

Various recording methods

View information in the display window	29
Recording for a long time (MDLP)	30
Manually adjust the recording level	31
Recording Add a track mark to. 32 Record with a microphone	33
Recording in groups	34
According to the recording source Start / stop recording (synchronized recording)	35
Recording from TV or radio (analog recording)	36

Various ways of regeneration

View information in the display window	37
Select a playback mode	38
Favorite sound (Virtual surround, 6-band equalizer)	41
Change the playback speed (Digital pitch control)	44
Listen with your system (LINK OUT)	45

To edit

Before editing	47
Set up a group	47
Canceling a group	49
Give a name (name)	49
Change the order of songs (move)	53
Divide songs (divide)	56
songs in one (combine)	57
Erase songs (erase)	58

Use by connecting to a computer

What you can do by connecting to a computer ...	60
Connect to a computer	60

various settings

Set the clock	62
Turn off the confirmation sound	63
Change the movement of the jog dial	63
Recording without overwriting	64
Listen to the sound quickly (quick mode)	64
Reduce battery consumption	65
Suppresses sound leakage and makes the sound easy on the ears (AVLS-auto volume) Limiter-System-Comfortable volume)	66
Display window Turn on / off the backlight of	66
Input with a personal computer, etc. View the title of the kanji you have used	67
Adjust the shade of the display window (contrast adjustment)	67
Sounds an alarm (melody timer)	68
Store settings for each disk (Personal disk memory)	69

others

Precautions for use	71
Main specifications	73

When in trouble • Q & A

When in trouble

Is it a malfunction? If you think	75
Message list	83
Warranty and after-sales service	86

MD know
Q & A

You can also do this ...	87
--------------------------	----

Index	95
-------------	----



Failure to follow the precautions below may result in serious injury due to fire or electric shock.

Do not use while driving • Never

use headphones, earphones, etc., perform detailed operations, or look at the display screen while driving a car or motorcycle. It may cause a traffic accident.

- Also, when using while walking, pay close attention to the surrounding traffic and road surface conditions to prevent accidents.



Do not allow water or foreign matter to get inside.

Water or foreign matter may cause a fire or electric shock. In the unlikely event that water or foreign matter gets in, turn off the switch immediately.

Unplug the AC power adapter from the outlet, disconnect the dedicated USB cable from the PC, and contact the store where you purchased the product or Sony's service counter.

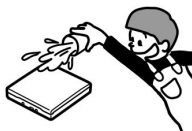

Do not use domestic dedicated machines overseas

AC adapters other than the world model are for use only in Japan. Please use with an AC 100V power supply. Using it with different voltage sources, such as overseas, may cause a fire or electric shock.



If thunder starts, you may get an electric shock without touching the power plug.



Do not use a charging station, AC power adapter, car battery cord, etc. other than specified. Explosion, liquid leakage, overheating, etc. may cause fire, injury or stain on the surrounding area.



The main unit and attached devices

that can not be opened unnecessarily may cause a fire or electric shock if opened or modified unnecessarily.



分解禁止

Do not touch the AC power adapter or charging station with wet hands .
It may cause an electric shock.



ぬれ手禁止

If you do not use the main unit, AC power adapter, or charging stand covered with a cloth, the case may be deformed or a fire may occur due to heat buildup.



禁止

Do not charge or leave it near a fire or under the scorching sun
The internal temperature may rise, causing a fire or malfunction.



禁止

Do not place metal on the charging stand If the
terminal of the charging stand is connected to metal, it may short-
circuit and generate heat.



禁止

Do not carry or store the main unit or battery case with metal. If you carry or store
it with metal such as coins or key necklaces, it may cause a short circuit and
generate heat.



禁止



If you do not follow the precautions below, you may be injured or damage the surrounding household goods.

Do not listen too loudly for a long time. If you listen for a long time at a loud volume that stimulates your ears, it may adversely affect your hearing. Be especially careful when listening with headphones. Listen at a volume that allows you to be called and answered.



Do not turn up the volume too much from the beginning. Suddenly, a loud noise may be heard and your ears may be damaged. Increase the volume gradually. Be especially careful when listening to digital devices with low noise, such as MDs, CDs, and DATs, with headphones.



Do not touch the AC power adapter, charging stand, or product while the power is on for a long time.

Leaving the skin in contact for an extended period of time can cause low-temperature burns.



Battery safety precautions Avoid serious injury or

blindness due to liquid leakage, explosion, heat generation, ignition, accidental

Therefore, please be sure to observe the following.

For the type of battery, check the display on the battery body.

Some notes may not apply depending on the type.

Rechargeable battery

Nickel metal hydride

(Ni-MH)

Batteries

alkali



If the rechargeable battery or dry battery leaks

If the rechargeable battery or dry battery leaks, the liquid that you do not touch with your bare hands may remain inside the main unit. Please contact the customer service center or Sony service center.

If the liquid gets into your eyes, it may cause blindness. Do not rub your eyes. Immediately wash your eyes with clean water such as tap water and see a doctor immediately. If the liquid gets on your body or clothes, it may cause burns or injuries, so wash it off immediately with clean water and consult a doctor if you have any symptoms of skin irritation or injury.



About rechargeable batteries

- Enter + and-correctly according to the display of the device.
- Do not charge with anything other than the specified charging stand and AC power adapter .
- If a rechargeable battery carrying case is included, be sure to put it in the carrying case for carrying and storing.
- Do not put in fire. Do not disassemble or heat.
- Do not use, store or leave the product in a hot place such as near a fire, in direct sunlight, or in a car under the scorching sun.
- Carry with metal such as coins, keys, necklaces

Do not store. Do not short.

- Do not peel off or damage the exterior vinyl tube

stomach.

- Do not use leaked batteries.
- Do not use rechargeable batteries other than those specified.
- Remove the used battery. When not using for a long time
Remove it when using it with an AC power supply.
- Do not mix different types of batteries.



About batteries

- Keep small batteries out of the reach of children as they can be swallowed. If swallowed, it may cause suffocation or stomach damage, so consult a doctor immediately.

- Enter + and-correctly according to the display of the device. • Do not charge. • Do not put in fire. Do not disassemble or heat. • Carry with metal such as coins, keys, necklaces

Do not store. Do not short.

- Do not use leaked batteries. •

Remove the used battery. When not using for a long time

Remove it when using it with an AC power supply.

- Mix new batteries, used batteries, and different types of batteries.

I don't know.

- If the + and-of the dry cell or the terminal of the dry cell case and the terminal for the dry cell case of the main body are connected to metal, it may short-circuit and generate heat.

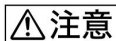

About batteries

- Do not use, store or leave the product in a hot place such as near a fire, in direct sunlight, or in a car under the scorching sun. • Do not peel off or damage the exterior vinyl tube

stomach.

- Do not use batteries other than those specified.

Request

Used rechargeable batteries are a valuable resource. Take some processing such as attaching tape to the terminals (metal parts) and bring it to a rechargeable battery recycling partner store.

Check the accessories

- Headphones

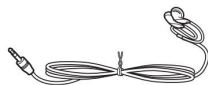

- Remote control

(supports Chinese characters and kana display)



- AC power adapter



- Charging stand

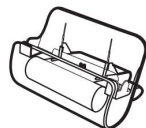

- Dedicated USB cable • Rechargeable nickel-metal hydride battery



NH-14WM (A)

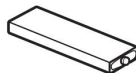

- Rechargeable battery case

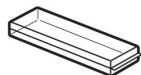

- Carrying pouch • Battery case



(No DC IN jack)



- MZ-N920 Instruction

Manual • CD-ROM (SonicStage Ver.2.0 / MD Simple Burner Ver.2.0) * •
Installation / Operation Guide

SonicStage Ver.2.0 / MD for Walkman MD Simple Burner Ver.2.0 • Warranty

• Sony consultation desk information • Customer registration request

* Do not play the CD-ROM on a music CD player.

please note

When using this machine, be sure to observe the following to prevent the cabinet from being deformed or damaged. • Put the unit in the back pocket of your pants, etc.

I can't sit down.



• Put the remote control / headphones wrapped around the main unit in the bag, and do not apply great force from the outside.

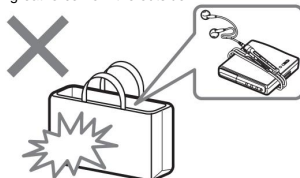

Name of each part

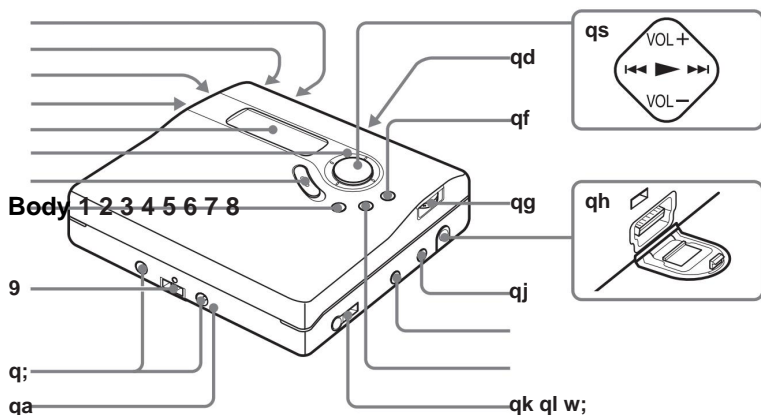

- 1 END SEARCH button
2 TRACK MARK button

Rechargeable battery

holder ^{hold} HOLD switch (back side)

If you move it in the direction of the arrow, you will not be able to operate the main unit. When you put it in a bag and carry it around, it prevents the button from being

pressed and malfunctioning. **5** Display window **6**

Charging lamp **7** Recording REC knob / lamp **8**

X (pause) button **9** Charging stand mounting jack

q; Battery case mounting terminal **qa** DC IN 3V

jack **qs** Centralized control key

^{open} **qd** OPEN knob

^{group} **qf** GROUP button **qg**

Jog dial

^{Menu enter} (MENU / ENTER)

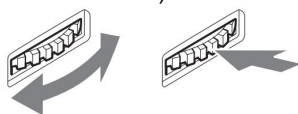

Turn to select

Press to decide

qh USB cable connection jack **qj** **qk** **ql**

^{Line-in optical} **x** (stop) LINE IN jack **w;**

^{Microphone plug-in power} **MIC (PLUG IN POWER) Jack ***

^{Link out} **i / LINK OUT jack**

* Convex points (protrusions) are attached. Please use it as a mark of operation.

operation	function
Press N * Play . Press	
Cue, fast rewind	
Press> Cue, fast forward	
^{volume} Press VOL + *, - Volume control	

Display window (main body)

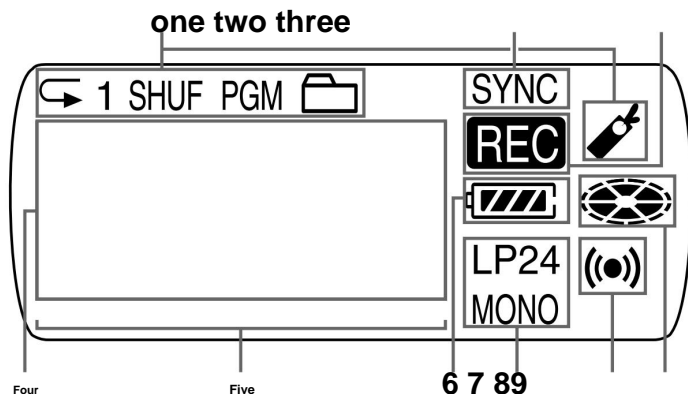
**1 Playback mode display**

Displays the playback status of shuffle playback, program playback, repeat playback, group playback, book mark playback, and so on. **2**

Synchro recording display **3** Recording display

Displayed during recording. Blinks when recording is

paused. **4** Character information display section The disc name, song name, date, error display, song number, etc. are displayed in characters.

5 Level display 6 Battery

level display Shows an

estimate of the remaining battery level of rechargeable batteries and dry batteries.

7 Recording mode display

LP2 stereo / LP4 stereo / MONO **8** Melody ^{monaural}

timer display **9** Disc display During recording and playback, the disc display rotates.

Remote controller

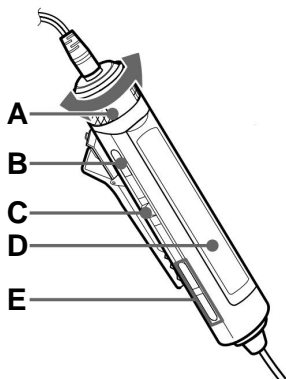

- 1 ^{volume} VOL (volume) +, - knob
 2 x (stop) button 3 jog lever

(NX / ENT ^{enter} •. ➤)

operation	function
Press u	Play, press again to pause menu
Press ENT	selection Cue, fast
.Press	rewind
Press>	Cue, fast forward

4 Display

wind ^{by} 5 (Group) +, - Button

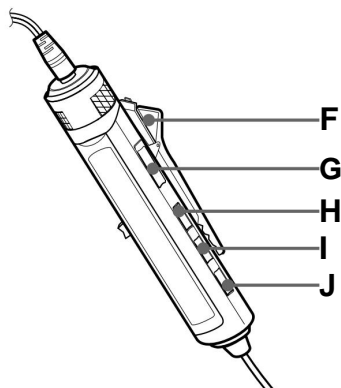

6 clips 7

^{hold}
 If you shift the

HOLD switch in the direction of the arrow to display the yellow mark, you will not be able to operate the remote control. When you carry it in a bag, etc., it prevents the button from being pressed and malfunctioning.

- 8 ^{display} DISPLAY button
 9 ^{Play mode} P MODE / ^{button} button
 0 ^{sound} SOUND button

How to use the remote control clip

You can also remove the clip and attach it in the opposite direction.

To remove

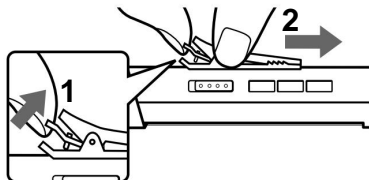

To put it in the opposite direction

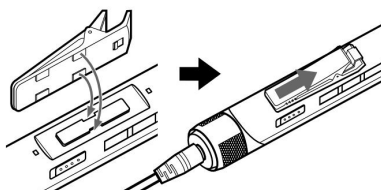

Display window (remote control)

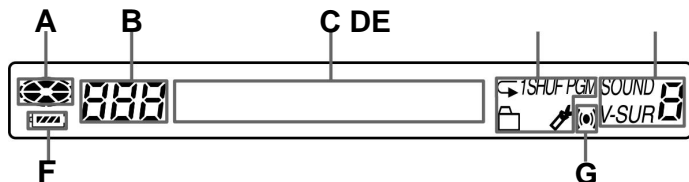

1 Disc display 2 Song

number display 3

Character information

display 4 Playback status display

5 Sound display 6

Battery level display 7

Melody timer display

prepare

At the time of purchase, first charge the rechargeable battery. However, if you connect the AC power adapter to the main unit, you can use it without charging.

1 Insert the rechargeable battery 1 Put the lid

of the battery holder in the direction of the arrow 2 Insert the rechargeable battery.

Push it toward you and slide it.

Please insert it with the E side in the back.

3 Close the lid.

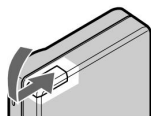
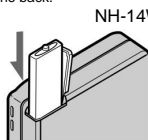
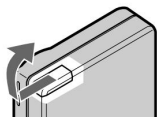

2 Charging 1

Charging stand and AC power adapter

Connect and connect to an outlet.

2 Place the main unit on the charging stand.

Outlet
To AC 100V

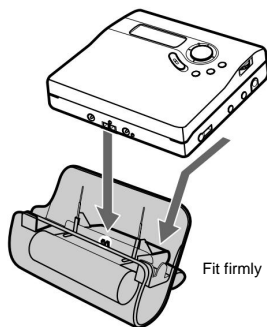
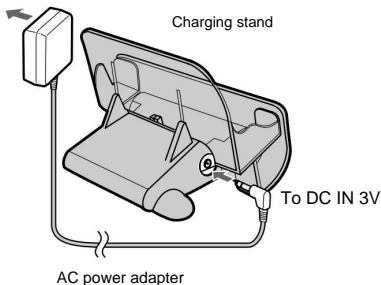

3 Confirm that the charging lamp is lit. 4 When the charging lamp goes out, charge the main unit.

Remove from the window.

"Charging" is displayed when charging starts

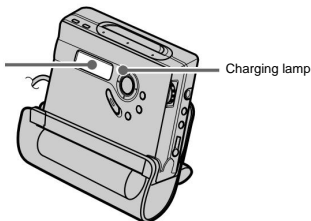

Z

When the charging lamp goes out immediately after charging, it is fully charged. If you start charging from the used up state, the charging lamp will go out in about 3.5 hours and charging will be completed.

3 Connect the remote control and release the

1 Connect the remote control to the main unit.

hold. 2 Release the hold.

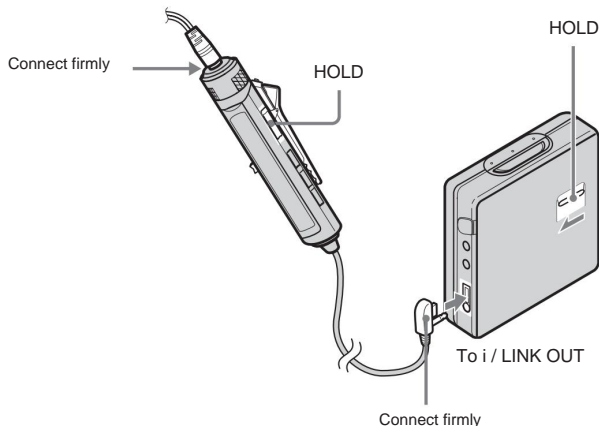

When using with alkaline batteries and using for a long time

1 Attach the battery case to the main body.

2 Insert one Sony alkaline battery (AA). Be sure to insert from the E side.

The back of the main body

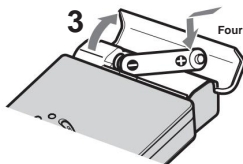
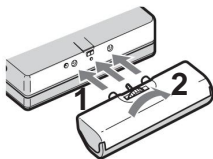

Z

You can also charge by connecting the AC power adapter directly. Connect the AC power adapter to the DC IN 3V jack of the main unit, and x • CANCEL • while stopped

Press the CHG button. "Charging" flashes and charging starts. It takes about 3.5 hours from the fully discharged state to the completion of charging. When the e display disappears, charging is complete. The charging time depends on the usage status of the rechargeable battery.

please note

- Charging will stop if you perform operations such as playback while charging. • Even if you place the main unit on the charging stand, the charging lamp may not light up immediately, but it will be displayed for a while and charging will start. • The life of the rechargeable battery may be short at the time of purchase or if it has not been used for a long time. This is due to the characteristics of the battery, and it will be fully charged after repeated charging and discharging several times. • When using for a long time for recording, etc., it is recommended to connect it to the power supply (outlet) for the garden. If you are using batteries, be sure to fully charge the rechargeable batteries to prevent failure due to battery drain. When using batteries, please use new batteries. • Charge at a temperature within + 5 ° C to + 40 ° C.

Please.

The charging time will be notified during use by displaying the remaining battery level on the display window of the main unit or remote control.



The battery is low.

m



The battery is dead.

m



There is no remaining amount. "LOW

BATT" flashes in the display window and the power turns off.

The battery level display is not the actual level, but is displayed as a guide even for Akuma. It may increase or decrease depending on the operating conditions and environment.

Battery life 1) Battery

life may be shorter depending on the ambient temperature, usage conditions, and battery type.

(JEITA2))

Recording battery Stereo LP2 stereo	LP4 stereo
-------------------------------------	------------

Rechargeable battery 3) Approximately 10 hours Approximately 13 hours Approximately 15 hours

Alkaline batteries 4)	About 11 hours	About 17 hours	About 20 hours
-----------------------	----------------	----------------	----------------

Rechargeable battery + alkaline battery	About 27 hours	About 36 hours	About 45 hours
---	----------------	----------------	----------------

Batteries used for playback Stereo LP2 stereo	LP4 stereo
---	------------

Rechargeable battery 3) Approximately 31 hours Approximately 36 hours Approximately 44 hours

Alkaline batteries 4)	About 44 hours	About 58 hours	About 69 hours
-----------------------	----------------	----------------	----------------

Rechargeable battery + alkaline battery	About 78 hours	About 100 hours	About 116 hours
---	----------------	-----------------	-----------------

1) This is the value when the power save function is ON.

2) Measured values according to JEITA (Japan Electronics and Information Technology Industries Association) standards is.

3) Rechargeable nickel-metal hydride battery NH-14WM

(A) 4) Measured with Sony alkaline battery LR6 (SG) made in Japan is.

Record

This section describes how to use an optical digital cable to connect to a CD player or BS tuner for digital recording. Please prepare an optional optical digital cable.

1 Insert a recording disc 1

Move the OPEN knob.

The lid will open.



2 Arrow with the label side of the disc facing the lid

Push it all the way in the direction of and close the lid.

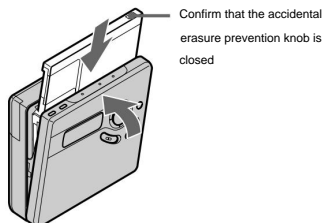

Basic

Connect **two** (Please insert firmly to the back.)

To the outlet

AC power
adaptor

CD player, MD player,
DVD video player etc.



To DC IN 3V



To optical digital output jack

Square plug

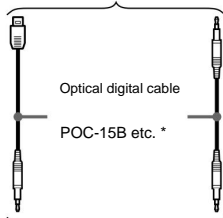

Optical mini plug

* For details, refer to "
Accessories sold
separately " (page 74) .

To LINE IN (OPT)

3 Record

1 Pause the CD you want to record.

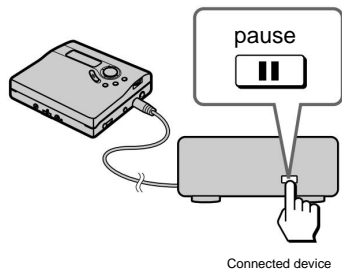

2 While stopped, hold down the REC knob and shift

vinegar.

"REC" display and REC in the center of the REC knob

The lamp will light up and recording will begin.

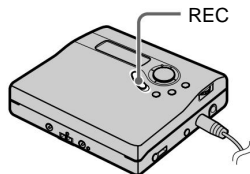

3 Start playing CD etc.

The song number is in the same place as the recording source CD etc.
will arrive.

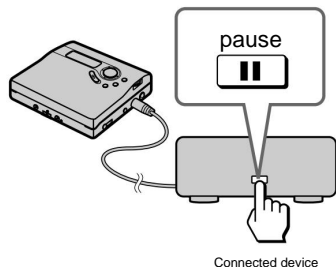

In such a case

operation

stop

Press x.

Take out the

Press X. 1) Press it again to cancel.

disc to pause Press x, then slide the OPEN knob on the main unit to open the lid.

(The lid will not open until the "TOC Edit" display disappears.)

1) When paused, the song number (track mark) increases by one, and the next song is recorded from there.

If you cannot start recording • Check the hold (malfunction prevention) switch . (Pages 14 and 19). • Check the disc erasure prevention knob.

Please. (Page 73).

- Play-only discs cannot be recorded.

Checking the recording status

The REC lamp lights up or flashes to inform you of the recording status. Recording status During recording

	display
	Lit
	Blinks according to the strength of the sound during microphone recording (voice mirror) Blinks
Recording pause	
When the recording disc has less than 3 minutes left	Flashing slowly
When a track mark (song number) is added *	Turns off for a moment
When transferring songs	Flashes fast

* Except when adding a track mark manually or when adding it with the auto time mark function (page 32) .

please note

- When recording, we recommend connecting the AC power adapter directly to the main unit. When recording with the main unit placed on the charging stand, insert a fully charged rechargeable battery into the main unit for recording so that recording can be continued even if the main unit is removed from the charging stand.

- While the "TOC Edit" display is blinking, the recorded information (start / end position of the song, etc.) is recorded on the disc. If you give a shock or unplug the power, the recorded content will not be recorded. • If the battery is removed, the AC power adapter is removed, or the battery is exhausted during recording or editing, or before the "TOC Edit " display disappears after pressing the x button , turn on the power next. The lid will not open until you insert it. • When recording from a portable CD player

Kiha

- Some portable CD players cannot output light without an AC power adapter connected . In that case, connect the AC power adapter to the portable CD player and use it with a household power supply. — Some portable CD players cannot output light when the skip guard function (ESP, G-PROTECTION, etc.) is turned on . In that case, turn off the skip guard function .

Z

You can hear the sound during recording. Connect a headphone with a remote control to the i / LINK OUT jack. The loudness of the sound you hear can be adjusted by turning VOL +, on the remote control (pressing VOL +, on the main unit). However, the loudness of the recorded sound is not affected.

Reproduce

1 Insert a disc

Insert a pre-recorded disc.

- 1 Move the OPEN knob.
The lid will open.



- 2MD with the label side on the lid side and the direction of the arrow
Push it all the way in and close the lid.

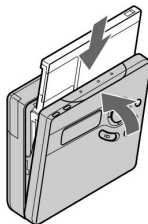

2 Listen

- 1 Press N. Jog lever on the remote control

Press (NX).

When you operate it, you will hear a beeping sound.

- 2 Press VOL +, to adjust the volume. Li

On Mokon, turn the VOL + and-knobs to adjust the volume. You can check the volume in the display window.

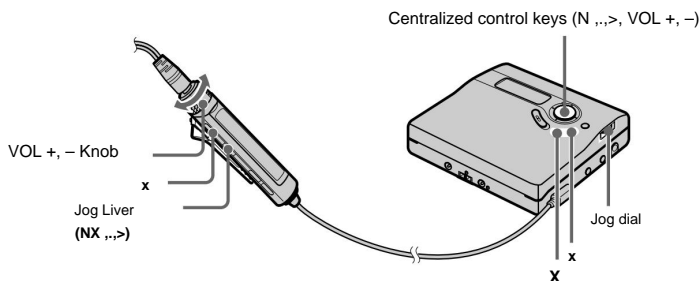

Press x to stop. When you

operate it, you will hear a beeping sound. After

stopping, the power will be turned off automatically after about 10 seconds when using the battery and about 3 minutes when using the AC power adapter . The next time you play, it will start from where you stopped.

In such a case	Main unit operation	Remote control operation
stop	Press x.	Press x.
Pause	Press X. Press it again to cancel.	Press the jog lever (NX). Press it again to cancel.
Directly select a song number or song name (direct song selection)	Turn the jog dial to display the song you want to hear, and press it.	--
Clarify the song you are listening to or the song before	.Press. Or press as many songs as you want to return.	Move the jog lever to the side. Or just the number of songs you want to return .
Cue the next song > Press.		Move the jog lever to> side.
Fast rewind / fast forward while playing Search for the place	Hold down. Or>.	Keep the jog lever. Or> sideways .
you want to hear while watching the elapsed time (time search)	Hold down. Or> while pausing .	While paused, keep the jog lever. Or> shifted to the side.
Find the place you want to hear while looking at the song number (Index	Hold down. Or> while stopped .	While stopped, keep the jog lever. Or > shifted to the side.
search) Cue every 10 songs 1) Press GROUP and then. Or >.		 Press + or -.
Start playing from the first song on the disc	Hold N for at least 2 seconds while stopped.	Hold down the jog lever for at least 2 seconds while stopped (NX).
Remove the disc Press x and then slide the OPEN knob to open the lid 2).		After pressing x, move the OPEN knob on the main unit to open the lid 2).

1) During group playback, the group will be cued (page 39). 2)

When the lid is opened, the next playback will start from the beginning of the disc (when registered in the personal disc memory). except for).

If playback cannot be started ,

check the hold (prevention of erroneous operation) switch (pages 14 and 19).

please note

- The sound may skip in the following cases. •
- When a strong impact is continuously applied •
- When listening to a scratched or dirty disc

How to operate the menu

Use the menu to operate convenient functions for recording, playback, and editing on this unit. Follow the procedure below to operate the menu.

To operate with the remote control

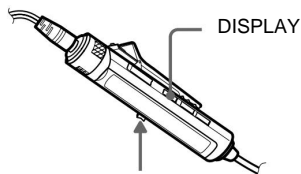

- 1 Press DISPLAY for 2 seconds or longer.

The menu screen will be displayed.

- 2 Shift the jog lever and select an item.
 - 3 Press the jog lever to confirm the item.
 - 4 Repeat steps 2 and 3 according to the display.
- The setting is confirmed when the jog lever is pressed last.

To operate with the main unit

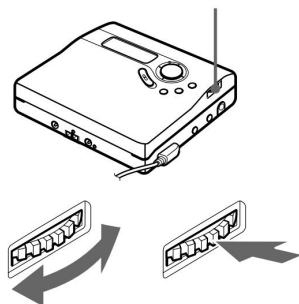

- 1 Press the jog dial.
- The menu screen will be displayed.
- 2 Turn the jog dial to select an item.
 - 3 Press the jog dial to confirm the item.
 - 4 Repeat steps 2 and 3 according to the display.
- The setting is confirmed when the jog dial is pressed last.

Press the x button to **go back to the previous stage**.

To **cancel in the middle**, press the x button for 2 seconds or longer.

Menu list



please note





The displayed items differ depending on the operation status and disk settings.

Remote control menu

The first floor	Second level	function	reference page	Chastity Written of beginning eye Ru Before To
EDIT	Name	Give song name, disc name, group name	49	
	Group Set	Set up a group	47 47	
	GroupRelease Release a group		49	
	Move	Change the order of songs and groups	53	
	Erase	Erase songs and groups	58	
USEFUL	Record the PERSONAL disk settings		69	
	Melody Timer Sounds an alarm (melody timer)		68 68	
	DPC	Change the playback speed	44	
OPTION	AVLS	Suppress sound leakage from headphones Set the	66 66	
	BEEP	confirmation sound	63 63	
	BACKLIGHT	Set the backlight of the remote control display window 66		
	Select display method Set display Kanji priority / Kanji / Kana alternate settings 67			
	PowerMode Starts playback quickly Reduces battery consumption		64 65 65	

Main body menu

The first floor	Second level	function	reference page	
EDIT	Name	Give song name, disc name, group name	50	
	 : Set	Set up a group	48	
	 : Release the Release group		49	
	Move	Change the order of songs and groups	54	
	Erase	Erase songs and groups	59	
DISPLAY	Lap Time			
	RecRemain			
	(Stopped / Recording) /			
	1 Remain			
	GP Remain			
	AllRemain	View information in the display window	37 37	
	Title Title			
	Sound			
	Clock			

The first floor	Second level	function	reference page
PLAY MODE1) Normal		Normal playback	
	1 Track	Play one song	
	 TrPLAY	Bookmark playback	
	Shuffle	Shuffle Playback	
	Program	Program playback	40
	 : Normal2) Group playback		
	 : Shuffle2) Group shuffle playback		
SOUND	 : Program2) Group program playback		
	SOUND OFF Default setting		
	V-SUR	Change the presence of sound (virtual surround) 43	
	SOUND EQ Change sound quality (6-band equalizer)		
USEFUL	Record the PERSONAL disk settings		70
	M-TIMER	Sound an alarm (melody timer)	69
	DPC	Change the playback speed	45 45
	Set AUDIO OUT headphones, LINK OUT 3)		45 45
REC SET	REC MODE Set the recording mode		30
	RecVolume Manually set the recording level		31
	TIME MARK When recording, add a track mark at regular intervals 32		
	MIC SENS	Set the microphone sensitivity when recording with a microphone	33 33
	 : REC	Make a group recording	34
	SYNC REC Synchro recording Suppresses		35
OPTION	AVLS	sound leakage from headphones	66 66
	BEEP	Set the confirmation sound	63 63
	REC-Posi	Set the recording start position	64
	PowerMode Starts playback quickly Reduces battery consumption		64 65 65
	CONTRAST Set the shade of the main unit display window		67 67
	JOG DIAL	Change the movement of the jog dial	63 63
	CLOCK SET Set the clock		62

1) After selecting the playback mode on the second level in PLAY MODE, repeat / do not repeat (Repeat ON / RepeatOFF) can be set. 2) Displayed when the disk is set as a group. 3) Displayed when the attached remote control is not connected.

Various recording methods

View information in the display window

While recording or stopped, you can check information such as remaining time and song number in the display window. The display related to the group function is displayed when the grouped song is played and stopped.

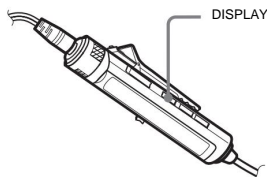

- 1 Press DISPLAY. Each time you press it, the display changes as follows.

Remote control display window

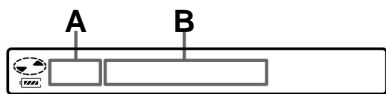

A	B
song number	elapsed time
Song number	Song title
Total number of songs in the group Group name	
Total number of songs	Disk name
Song number	Group name (upper) Song name (lower) Display by selected sound
Song number	mode
---	Current time

please note

The display may differ depending on the disk group setting status, operating status, and setting status.

Z

See "Viewing information in the display window" on page 37 for the display during playback.

Operate with the main body

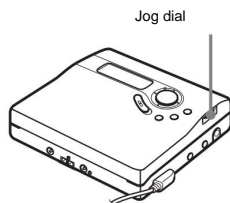

- 1 Select "DISPLAY" from the menu operation.
- 2 Turn the jog dial to display the information you want to check, and press it to confirm.

Display window of the main body

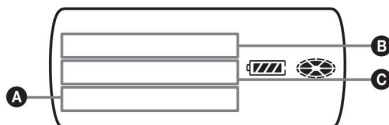

Each time you turn it, the display changes as follows.

LapTime **y** RecRemain **y** GP Remain **y**
 AllRemain **y** Title **y** Sound **y** Clock Press
 the jog dial to display the selected
 information in A, B, and C.

A (selected item) B	C
— (LapTime) Song number elapsed time	
RecRemain Song number Remaining time to record	
Number of songs remaining in the GP	Remaining time
Remain group	that can be played
	in the group
AllRemain Number of remaining songs Total remaining time that can be played	
Song name (Title) Disc name Group name Display by each	
Sound mode name selected sound mode	
(Sound)	

A (selected item) B	C
Clock	Date Current time

please note

The display may differ depending on the disk group setting status, operating status, and setting status.

Record for a long time (MDLP)

In addition to normal SP stereo recording, you can extend the recording time by 2 times (LP2) or 4 times (LP4) for stereo recording (MDLP recording). Also, monaural recording can be recorded twice as long as normal SP stereo recording.

The contents recorded on LP cannot be played on other devices that do not support MDLP playback.

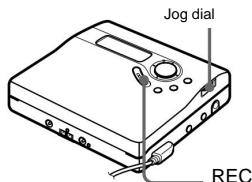

1 While stopped, select "REC SET"- "REC MODE" from the menu operation.

2 Turn the jog dial to display your preferred recording mode, and press to confirm.

Recording mode 1) Display Recording time 2)	
Stereo recording SP	About 80 minutes
LP2 stereo recording LP2	About 160 minutes
LP4 stereo recording LP4	About 320 minutes
Monaural recording 3) MONO about 160 minutes	

1) If you want to record with higher sound quality, select stereo recording or LP2 stereo recording. 2) When using the disk for 80 minutes. 3) When recording a stereo sound source in monaural, the left and right sounds are mixed and recorded.

4 Hold down the REC knob and slide it to start recording.

5 Start playing the recording device.

Press x to stop

recording . The

recording mode is remembered until the next recording.

Z

MDLP Or the **MDLP** with the logo supports "LP2 stereo" and "LP4 stereo".

please note

- When recording for a long time, we recommend connecting the AC power adapter.
- LP4 stereo recording employs a special compression method to achieve four times longer stereo recording than normal. Therefore, depending on the sound source of the recording source, momentary noise may occur in rare cases. If you want a higher quality recording, choose stereo recording or LP2 stereo recording.

Manually adjust the recording level

During recording, the recording level is automatically adjusted to the optimum value, but you can manually adjust it if necessary. It can be adjusted not only for analog recording but also for digital recording (digital REC level control).

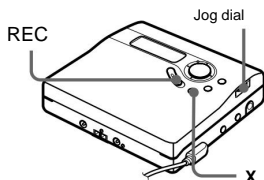

- 1 While holding down X, hold down the REC knob and slide it. Recording will be paused.
- 2 Menu operation "REC SET"-
Select "Rec Volume"-"Manual REC" .

3 Make the sound you want to record.

- 4 While looking at the display window, turn the jog dial to adjust the recording level. Adjust the recording level so that the level display bar lights up between A and B as a guide . If the light to the right of B lights up, lower the recording level. The level display bar displayed on the screen is divided as follows. Upper: L (left) level Lower: R (right) level

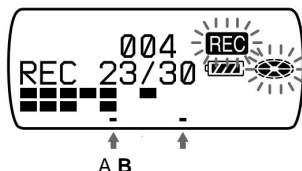

- 5 Press X to start recording.

When recording by connecting to another device, restart the recording source sound from the beginning after the unit starts recording.

To use automatic adjustment, select "Auto REC" in step 2 .

please note

- The left and right sound (channel) levels cannot be adjusted separately. • When you stop recording, the next recording will return to automatic level adjustment. • When adjusting manually during synchronized recording,

First, with the synchronized recording set to "SYNC OFF" (page 35), perform steps 1 to 4 above to adjust the recording level. After that, set the sync recording to "SYNC ON" and start recording.

Add a track mark during recording

You can add a track mark (song number) during recording to separate songs and recordings.

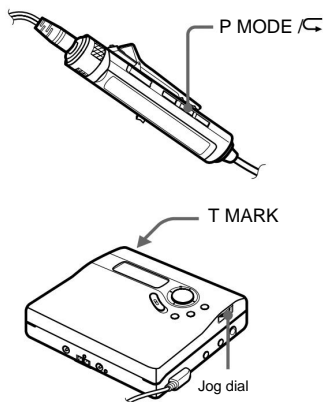

Attach manually

- 1 During recording, when you want to add a track mark, press T MARK (P MODE / on the remote control).

Automatically put on (auto time mark)

When making a long recording such as a meeting or lecture, you can automatically add a track mark at regular intervals and add a mark in the middle. This can only be set during microphone recording or analog recording.

- 1 While recording or pausing recording , select "REC SET"- "TIME MARK"- "ON" from the menu operation.

- 2 Turn the jog dial to display the desired time, and press to confirm. "TIME: 01" to "TIME: 99" (1 minute to 99 minutes) are displayed and can be set in 1 minute increments.

To cancel the setting,

select "OFF" in step 1. Or press x to stop recording.

How to add the auto time mark during recording •

When the recording time exceeds the set time of the track mark: The track mark is added when the setting is made, and then the track mark is added for each set time. Example) Recording time When the set time of the track mark is 8 minutes and the set time of the track mark is 5 minutes (TIME: 05), the track mark is actually attached at 8 minutes, 13 minutes, 18 minutes, 23 minutes ... • The recording time is the track mark. When it is shorter than the set time: A track mark is added every set time after the set time of the track mark is reached. Example)

When the recording time is 3 minutes and the set time of the track mark is 5 minutes (TIME: 05), the track is actually tracked. The mark will be attached for 5 minutes, 10 minutes, 15 minutes ...

Z

If you add a track mark with the auto time mark, a "T" will be added before the time display.

please note

- Press the T MARK button during recording ,
If you press X and the track mark is added, the
auto time mark will be added at the time set from
that point. • When you stop recording, the setting
is canceled.

Record with a microphone

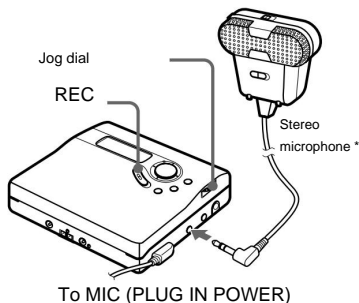

* For details, see "Accessories sold separately" (page 74).
Please to query.

- 1 Connect an optional stereo microphone to the main unit

important.

The input will automatically switch to the microphone
input.

- 2 Hold down the REC knob and slide it to start
recording.

Change microphone sensitivity

- 1 While stopped or recording, select "REC SET"-"MIC
SENS" from the menu operation .

- 2 Turn the jog dial to "SENS"

Display "HIGH" or "SENS LOW" and press to
confirm. • "SENS HIGH": When recording a normal
volume such as a conversation • "SENS LOW":

When recording a loud sound such as a live
recording

Z

If you are using a plug-in power type microphone,
power is supplied from the main unit, so you can use
it even if the power of the microphone is turned off.

please note

- Optical digital input, microphone input, and analog
input are automatically selected in that order. If
the optical digital cable is connected to the LINE
IN (OPT) jack , it will not be a microphone input.

- The operating sound of the main unit may be picked up.
In that case, move the microphone away from the
main unit to record the sound. Please note that
direct connection type microphones may pick up
noise. • When recording with a monaural
microphone, the left channel
You can only record.

How
to

make a sou

Record in a group

The group function

is a disc that has been set as a group, and you can use the "group function". This is a convenient function when recording several CDs on a single disc in MDLP (LP2 / LP4) mode, or when playing back a disc recorded by collecting single CDs.

What is a grouped disk? It means that multiple recorded songs are grouped into several groups on one disc as shown in the following figure.

Before group setting

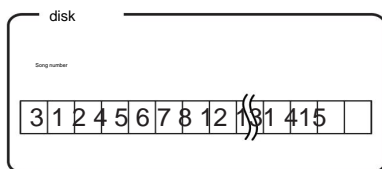

m

1st to 5th songs in "Group 1" 8th to 12th songs in "Group 2" 13th to 15th songs in "Group 3" 6th and 7th songs cannot be included in the group

Disk after group setting

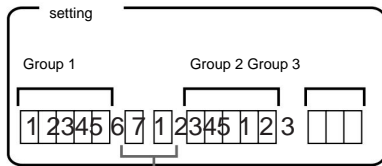

Songs that are not in the group are considered to belong to "Group ---".

You can create up to 99 groups on a single disc.

please note

If the total number of song titles and disc names on a single disc exceeds the maximum number of characters that can be input to this unit, group settings cannot be made. 34

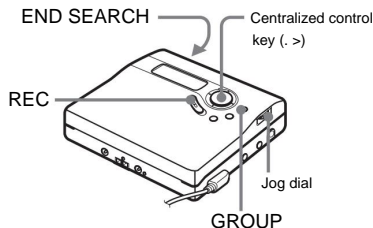

Create a new group and record

Add a new group to the end of the disc and record.

- 1 Press END SEARCH while stopped.
- 2 Hold down GROUP and hold down the REC knob. Hold down and shift.
- 3 Start playing the recording device.

A new group is added at the end of the disk.

Press **x to stop recording**. When you stop recording, it will be recorded as one group.

To always record in a group when recording

This setting enables group recording by simply pressing END SEARCH and moving the REC knob to the right while the next recording is stopped. This is convenient when recording multiple CDs for each album in succession, such as for MDLP recording. It can be operated only on the main unit.

- 1 While stopped, select "REC SET" -> "REC" from the menu operation.
- 2 Select " : REC ON".

Select " : REC OFF"

to restore the settings .

Additional recording to an existing group

Add a song to an existing group.

1 Press GROUP and press. Or>

Press to display the group to which you want to add a recording.

2 Hold down GROUP and hold down the REC knob

Hold down and shift.

3 Start playing the recording device.

Z

If you want to add a song to the group you are currently listening to and record it, pause or stop playback and proceed from step 2.

Start / stop recording according to the recording source (synchronized recording)

Starts or stops recording according to the sound of the recording source. When recording from a digital device such as a CD player connected using an optical digital cable to this unit, you can easily record without having to operate both the recording source and this unit. Synchronized recording is not possible without connecting with an optical cable.

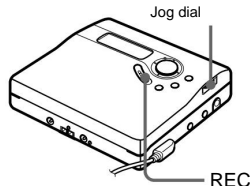

1 Connect. Use

an optical digital cable (sold separately) according to the recording source device. For details, see "Accessories sold separately" (page 74).

2 While stopped, use the menu operation to select "REC.

Select "SET"-"SYNC REC"-"SYNC ON".

3 Hold down the REC knob and move it.

The "REC" display and the REC lamp blink, and the recording standby mode is set.

4 Play the CD you want to record.

When sound is output from the recording source, recording will automatically start on this unit.

Press x to stop recording .

Z

If there is no sound for about 3 seconds at the recording source during synchronized recording, the unit automatically pauses recording. When the sound is detected again, it returns to the synchronized recording. Recording will stop automatically if the recording is paused for more than 5 minutes.

please note:

- During synchronized recording, you cannot manually pause or cancel the pause. • Do not switch the "SYNC REC" setting during recording. It may not be recorded correctly.
- Even if the recording source continues to be silent (page 92) during synchronized recording, the recording may not be automatically paused due to the noise of the recording source.
- If there is no sound (page 92) for about 2 seconds in the same song from the recording source during synchronized recording from a source other than a CD or MD, the song number will increase by one when the sound comes out again.

Record from TV or radio (analog recording)

When recording from "analog devices" such as cassette tapes, radios, and televisions, This is the method for recording from MD.

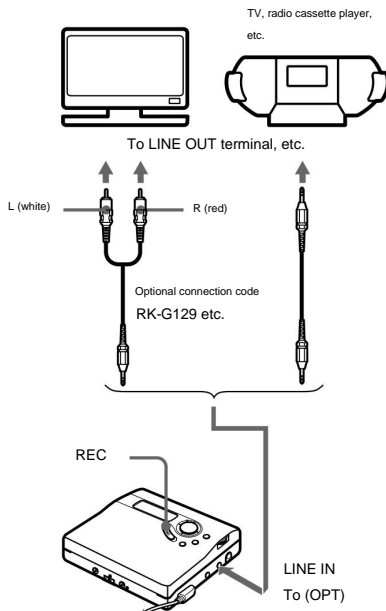

1 Connect.

Use the connection code (sold separately) according to the recording source device. For details, see "Accessories sold separately" (page 74) and "You can also do this" (page 87).

2 Hold down the REC knob and slide it to start recording.

3 Make the sound you want to record.

Various ways of playback

View information in the display window

During playback, you can check information such as the song title and disc name in the display window. The display related to the group function is the display during playback of the grouped songs.

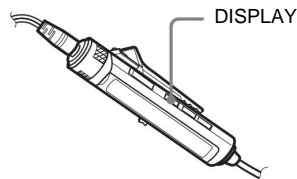

1 Press DISPLAY repeatedly during playback.

Each time you press it, the display changes as follows.

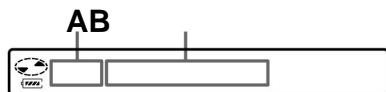

Display A / B

A	B
Song number	Elapsed time
Song number	Song title
Total number of songs in the group	group name
Total number of songs	Disc name
Song number	Group name (upper) Song name (lower)
Song number	Display by each selected sound mode Recording time

Song number	Mode when recorded

please note

The display may differ depending on the disk group setting status, operating status, and setting status.

Operate with the main body

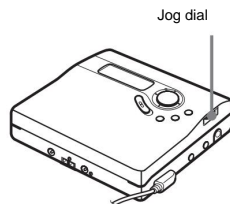

1 During playback, select "DISPLAY" from the menu operation .

2 Select the display mode you want to check.

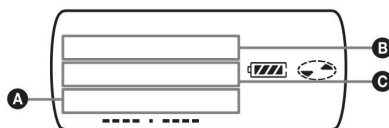

Display A / B / C

A (selected item)	B	C
— (LapTime)	Song number	elapsed time
1	Remain song number	Remaining time in one song
GP	Remain Group name	Remaining time that can be played in the group
All	Remain Number of remaining songs	Total remaining time that can be played
Song name (Title)	Disc name	Group name
Sound mode name (Sound)	Separate table for each sound mode	--
RecDate	Recording date	Recording time (Clock)

Various

Select a playback mode

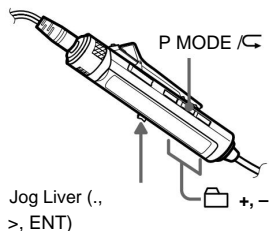

Press 1P MODE ↺ repeatedly.

Each time you press it, the display changes as follows, and it plays back in the selected display state.

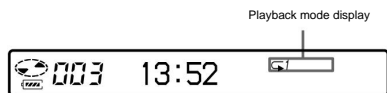

display	Playback state
--	Normal playback (plays all songs on the disc once)) Plays one song (plays only the song currently playing)
1	
	Bookmark playback (play only songs with bookmarks in order)
SHUF	Shuffle playback (play all songs in no particular order)
PGM	Program playback (play the songs you want to listen to in the order you like)
*	Group normal playback (playing each group in order from group 1) * Group shuffle
SHUF	SHUF playback (shuffle playback of songs in the group being played, then shuffle playback of songs in the next group)
PGM*	Group program playback Play by rearranging in the order you like in loop units)

* Displayed only when the disk is set as a group.

Z

During group playback, songs that are not set to a group on the disc are temporarily grouped together and treated as the last group. At this time, "Group --" is displayed. The song number is displayed as the serial number of the disk, not the number for each group.

Listen repeatedly (repeat playback)

You can listen to normal playback, single song playback, shuffle playback, program playback, and so on repeatedly.

Playing in your favorite playback mode,

Press P MODE ↺ for 2 seconds or

↺ longer. Lights up.

To cancel, press P

MODE / for 2 seconds or longer.

Z

If you press the P MODE / button during repeat playback, you can change the playback mode while keeping the repeat.

Select and listen to only your favorite songs (bookmark playback)

You can bookmark a song you like and play only that song. However, you cannot change the order of the songs.

To bookmark

1 Play the song you want to bookmark and press the jog lever for 2 seconds or longer. The first song of bookmark playback is confirmed.

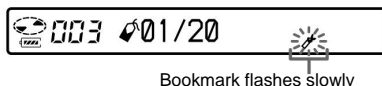

- 2 Repeat step 1 to bookmark. You can add up to 20 songs in total.

To play a bookmarked song

- 1 During playback, press **PGM** / repeatedly to display "Tr PLAY?".

- 2 Press the jog lever. Playback starts in order from the smallest song number with the bookmark.

To delete a bookmark, play the song for which you want to delete the bookmark, and press the jog lever for 2 seconds or longer.

please note

The setting is canceled when the lid is opened.

Arrange the songs in the order you like and listen (program playback)

- 1 During playback, press **PGM** / repeatedly to display "PGM".
- 2 **Move the jog lever to. Or >** to select the song number and press to confirm.

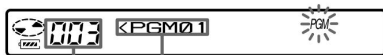

Song number Program order

- 3 Repeat step 2 to play the songs in the order you like.

Choose. You can program up to 20 songs in total.

- 4 After selecting, press the jog lever for 2 seconds or longer to confirm. The settings are confirmed and playback starts from the first song.

Z

The program settings remain even when playback ends or is stopped halfway.

please note

The setting is canceled when the lid is opened.

Group play

After playing each group in order from group 1, the ungrouped song ("Group- ") is played and finished.

During playback, press **PGM** / repeatedly to display "".

Various

How to cue a group (group skip)

Press + or during playback. Press the - button to move to the first song in the group, and then press it again to move to the first song in the previous group.

Arrange the groups in the order you like and listen (group program playback)

Display "PGM" in the same order as "Listen songs in the order you like (play program)" (this page), and set the order of the groups to play. You can program up to 10 in total. The order of the songs in the group cannot be changed.

Operate with the main body

Centralized control key
(. N >)

Jog dial

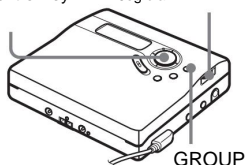

Select a playback mode

- 1 Select "PLAY MODE" by menu operation

Bu.

- 2 Select the playback mode you want to select.

If you select B, A lights up.

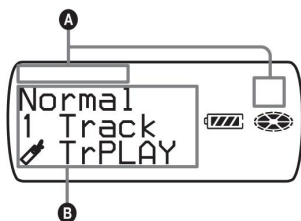

Display A / B	Playback state
— / Normal	Normal playback
1/1 Track Track	Play one song that is playing
/ TrPLAY	PLAY bookmarks are attached Play only the songs in order
SHUF / Shuffle	All songs are played in random order
Arrange PGM / Program songs in any order and play them normally. Group normal	
//	playback (playing from group 1 in order for each group)
: Normal *	
SHUF	In-group shuffle playback (replays the songs in the currently playing group by shuffling, and then shuffles the songs in the next group)
: Shuffle *	

Display A / B

Playback state



: Program *

Group program playback (play by rearranging in the order you like for each group)

* Displayed only when the disk is set as a group

- 3 Select "Repeat ON" (play repeatedly) or "Repeat OFF" (play without repeating).

When "Repeat ON" is selected, " " is displayed in A, and playback is repeated in the playback mode selected in step 2.

Select and listen to only your favorite songs (bookmark playback)

To bookmark

- 1 Play the song you want to bookmark,

Press N for 2 seconds or

longer. The first song of bookmark playback is confirmed.

- 2 Repeat step 1 to bookmark.

To play bookmarks

- 1 In step 2 of "Select playback mode"

Select "Tr PLAY" (this page).

- 2 "Repeat ON" or "Repeat OFF".

To cancel, play

the song whose bookmark you want to delete,

Press N for 2 seconds or longer.

Listen by rearranging the songs in the order you like (program playback)

- 1 "Select playback mode" Select "Program" in step 2.
- 2 "Repeat ON" or Select "Repeat OFF".
- 3 Turn the jog dial to select a song, and press it to confirm.
The selected song is confirmed.

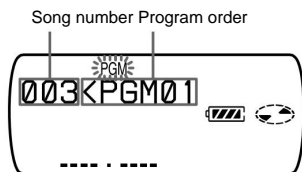

- 4 Repeat step 3 to play the songs in the order you like.
Choose.
- 5 After selecting, press the jog dial for 2 seconds or longer.

Group play

Select " : Normal" in step 2 of "Select playback mode" .

How to cue a group (group skip)

- 1 Press GROUP during playback.
2. Press or>.

Arrange and listen to **groups in the order you like (group program playback)** Follow the same procedure as "Listing songs in the order you like (program playback)" (above)
"Display " : Program" and set the order of the groups to be played. You can program up to 10 in total . The order of the songs in the group cannot be changed.

Make your favorite sound (Virtual Surround, 6-band equalizer)

You can change the presence of the sound and select and set your favorite sound quality with the remote control. You can choose one from the following two effects. • V-SUR (Virtual Surround): Change the presence of sound. (4 types) • 6 BAND EQUALIZER : Change the sound quality. (6 types)

Various

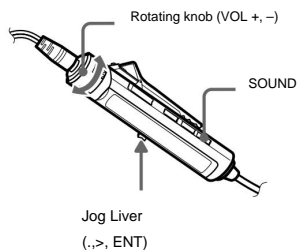

Change the sense of presence (virtual surround)

- 1 During playback, press SOUND repeatedly to press Select "V-SUR".
- 2 Press SOUND for 2 seconds or longer.

3 Move the jog lever to. Or> to the side

Then select the surround type.

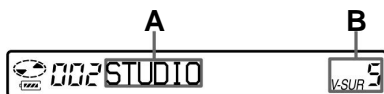

A and B each time you shift the jog lever
Changes as follows.

A	B
STUDIO	V-SUR S
LIVE	V-SUR L
CLUB	V-SUR C
ARENA	V-SUR A

4 Press the jog lever to confirm.

Choose sound quality
(6 band equalizer)

1 During playback, press SOUND repeatedly to press
Select "SOUND".

2 Press SOUND for 2 seconds or longer.

3 Move the jog lever to. Or> to the side

Then select the type of sound.

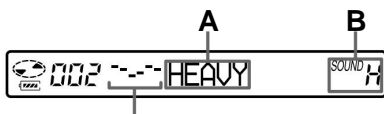

Level for each frequency 100Hz-10kHz

Every time you shift the jog lever, A and B
It changes as follows.

A	B
HEAVY	SOUND H
POPS	SOUND P
JAZZ	SOUND J
UNIQUE	SOUND U
CUSTOM1	SOUND 1
CUSTOM2	SOUND 2

4 Press the jog lever to confirm.

If you want to stop the setting on the way

Press x for 2 seconds or longer.

When canceling the setting

Nothing is displayed in B in step 1

To choose.

Make the sound quality you like

"CUSTOM 1" and "CUSTOM 2"

You can memorize your favorite sound quality

vinegar.

1 Perform steps 1 to 3 above,

"CUSTOM 1" or "CUSTOM 2"

Is displayed.

2 Press the jog lever.

3 Move the jog lever to. Or> to the side

Then select the frequency.



Frequency (100Hz)

You can choose the frequency from the following six.

100Hz, 250Hz, 630Hz, 1.6kHz, 4kHz,
10kHz

Turn the 4 -turn knob repeatedly to set the level.

Adjust.



Level (+ 10dB)

You can choose the level from the following 7 levels.

-10dB, -6dB, -3dB, 0dB, + 3dB, + 6dB,
+ 10dB

5 Repeat steps 3 and 4.

6 Press the jog lever to confirm.

If you want to stop the setting in the middle, press
x for 2 seconds or longer.

Press x to return to the
previous setting .

Operate with the main body

Centralized control key (VOL +, -, >)

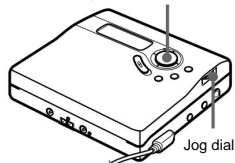

Change the sense of presence (virtual sound)

- 1 During playback, select "SOUND" -"V-SUR"
from the menu operation .
- 2 Turn the jog dial to select the surround type,
and press to confirm.

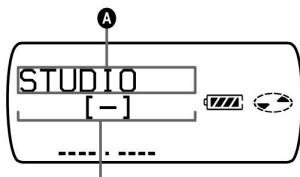

The display showing the sound quality setting is displayed
for each mode.

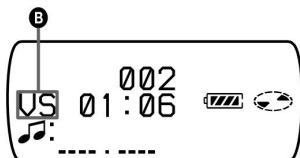

When you turn the jog dial, A changes
as follows, and when you press the jog
dial , B is displayed.

A	B
STUDIO	VS
LIVE	VL
CLUB	VC
ARENA	VA

Change the sound quality (6 band equalizer)

- 1 During playback, select "SOUND" -"SOUND
EQ" from the menu operation .
- 2 Turn the jog dial to select the type of sound,
and press to confirm.

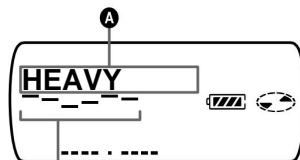

The level for each frequency (100Hz
to 10kHz) is displayed for each mode.

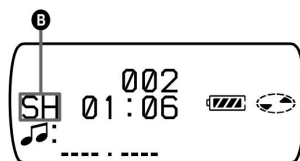

When you turn the jog dial, A changes
as follows. Press the jog dial to
display B.

A	B
HEAVY	SH
POPS	SP
JAZZ	SJ
UNIQUE	SU
CUSTOM1	S1
CUSTOM2	S2

Various

Make the sound quality you like

- 1 During playback, by menu operation

Select "SOUND"- "SOUND EQ"-
"CUSTOM 1" or "CUSTOM 2" .

2. Press **or >** to select a frequency
Bu.



Frequency (100Hz)

You can choose the frequency from the following six.

100Hz, 250Hz, 630Hz, 1.6kHz, 4kHz, 10kHz

- 3 Press VOL +, - to adjust the level.

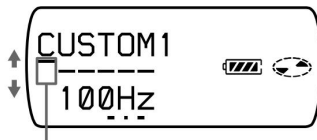

Level (+ 10dB)

You can choose the level from the

following 7 levels. -10dB, -6dB, -3dB, 0dB, + 3dB,
+ 6dB, + 10dB

- 4 Press the jog dial to confirm.

Select "SOUND OFF"
to cancel the setting .

Change the playback speed (digital pitch control)

This is convenient when you want to change the playback speed for language learning. Only the playback speed changes without changing the pitch. You can select the playback speed from 13 levels from + 100% to -50% .

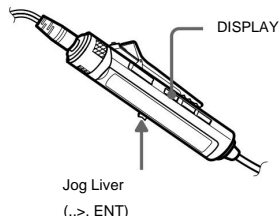

- 1 During playback, by menu operation

"USEFUL" — Select "DPC". The
playback speed setting screen is displayed.
Please choose while listening to the sound.

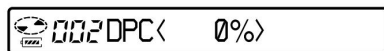

- 2 Move the jog lever to. Or > to select
the speed and press to confirm. "DPC"
is displayed in the display window.

If you want to stop the setting in the middle,
press x for 2 seconds or longer.

Press x to **return to the
previous setting .**

Z

When you insert or remove the disc, the setting returns to 0% .

please note

If you change the playback speed, you may hear a
"bubble wrap" sound or an echo during playback.

Operate with the main body



- 1 During playback, by menu operation
Select "USEFUL"-"DPC".
- 2 Turn the jog dial to select the desired speed and
press to confirm.

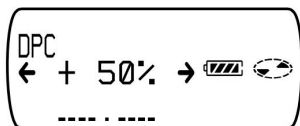

Listen with your system (LINK OUT)

You can listen to and record the playback sound of this unit with other audio devices.

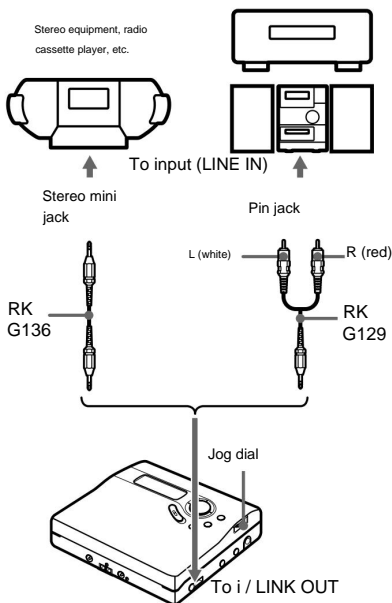

You need to connect the separately sold connection code RK-G129 or RK G136 to the i / LINK OUT jack of this unit, and then perform the following operations to set the i / LINK OUT output ("AUDIO OUT").

- 1 Menu operation "USEFUL"-
Select "AUDIO OUT"-"LINK
OUT" .

please note

- If the i / LINK OUT output ("AUDIO OUT") is set to "LINK OUT", volume, virtual surround, and 6-band equalizer will not work.
- Connect the included headphones with remote control
When is set, the i / LINK OUT output ("AUDIO OUT") setting cannot be set to "LINK OUT".
- When connecting headphones directly to the main unit, set the i / LINK OUT output ("AUDIO OUT") to "Head Phone".

To edit

Before editing

You can add a track mark (song number) to a minidisc, and add a song title or disc name.

please note

- Play-only minidiscs cannot be edited.
Hmm.
- Close the erasure prevention knob (73 pages ~Ji).
- While "TOC Edit" is displayed, the edited contents are recorded on the disk. — Do not give a shock. — Do not unplug the power. — The lid will not open.

Set up a group

You can group songs that have already been recorded, group multiple groups into one group, and group songs that are not included in the group. You can create up to 99 groups on a single disc .

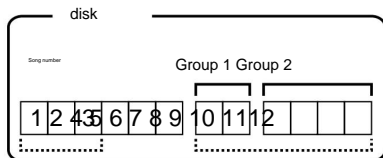

Combine the 1st to 3rd songs into "Group 1" Combine "Group 1" and "Group 2" into one group

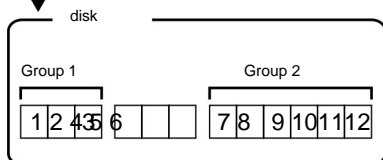

It is not possible to combine non - consecutive song numbers or groups such as 1 and 3, 2 and 4, 3 and 7, 8, 4 and 9-12 . During operation, the song number is displayed as the serial number on the disc.

please note

- If the total number of song titles and disc names on a single disc exceeds the maximum number of characters that can be input to this unit, group settings cannot be made.
- Only consecutive songs or groups can be combined. If you want to combine songs or groups that are not consecutive, rearrange the order of the songs or groups (pages 53 to 55), and then arrange the songs or groups that you want to combine.

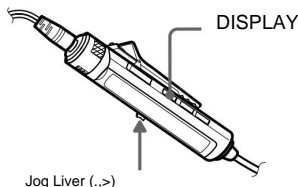

1 While stopped, select "EDIT" - "Group Set" from the menu operation.

2 Shift the jog lever to select the song you want to be the head of the group, display it, and press it to confirm.



3 Shift the jog lever to select the song you want to be at the end of the group, display it, and press it to confirm.

4 Give a group name (see steps 3-5 of "Name" (pages 50 and 51)).

To stop the setting in the middle, press x for 2 seconds or longer.

Press x to **return to the previous setting**.

please note

- In step 2, you can only select the first song in an existing group or a song that has not been grouped.
- When selecting the last song in step 3, you can only select songs after the song selected in step 2. Also, the last song in the group you want to combine can only be the last song in an existing group or a song that has not been grouped.

Operate with the main body



1 While stopped, select "EDIT" - "Set" from the menu operation.

The song number of STR (first song) flashes.

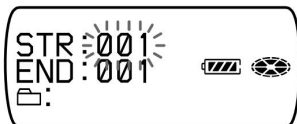

2 Turn the jog dial to select the song you want to be the first song in the group, display it, and press it to confirm. The first song of the group you want to put together is selected.

3 Turn the jog dial to display the song you want to play at the end of the group, and press it to confirm. The last song of the group you want to put together is selected, and you can enter the group name.

4 Give a group name (see "Name" (pages 50-52)).

Ungroup

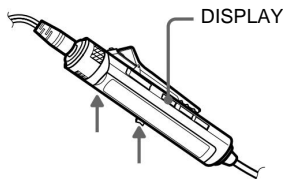

1 Select the group you want to cancel ("How to cue a group (group skip)" (page 39)) and check the contents.

2 Press x.

3 Select "EDIT"->"Group Release" from the menu operation. "Release?" And "Push ENTER" are displayed.

4 Press the jog lever to confirm.

Operate with the main body



1 Select the group you want to cancel ("How to cue a group (group skip)" (page 39)) and check the contents.

2 Press x.

3 Select "EDIT"->"Release" from the menu operation. "Release?" And "Push ENTER" are displayed.

4 Press the jog dial to confirm. The group will be released.

To stop the setting in the middle, press x for 2 seconds or longer.

Press x to return to the previous setting.

Give a name (name)

You can use the character palette to name or change the song title or disc name.

Types of characters that can

be entered • Katakana (half-width) • Uppercase letters A to Z, small sentences

Letters •

Numbers 0-9 • Symbols! " # \$% ; < @] (Space) _ & () * . ` + / = > ?

Number of characters that can be

entered Approximately 200 characters for each song name and disc name (when all character types are mixed)

Number of characters that can be entered on one disc • For

alphanumeric / symbols only: Approximately 120 titles with

approximately 10 characters (maximum approximately 1700 characters)

• For kana characters only: Approximately

60 titles with about 10 characters (maximum approximately

800 characters) The number of titles that can be registered

varies depending on the number of characters.

About the character palette

On the main unit, select and enter characters from the character palette that appears in the display window. The character array of the character pallet is as follows.

アイウエオカキクケコサシスセソタツテトナニヌネノハヒフヘホ
 マミムメモヤヨラリルレロワン * ° - アイウエオヤヨツ
 ABCDEFGHIJKLMNOPQRSTUVWXYZ 123
 abcdefghijklmnopqrstuvwxyz 456
 . , - ? ! & ' " / @ ; : () # \$ % < = > ^ + _ 0 789

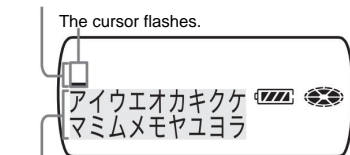
Input area

Character palette

As you can see, only a part of the character palette is displayed in the display window, so move the cursor with the central control key to select a character.

please note

- Please note that if you put "/" between characters such as "abc // def" in the disk name or group name, you may not be able to use the group function.
- You can display Chinese characters with the attached remote control, but you can not name them in Chinese characters. You can enter Chinese characters using the included SonicStage software.

Give a name

You can name it while playing, recording, or stopped. However, when naming a song while it is stopped, make sure to select the song you want to name. When naming a group, make sure to select a song in the group you want to name while playing, recording, or stopping.

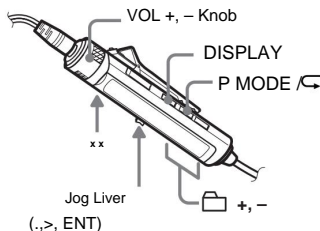

1 Select "EDIT"->"Name" from the menu operation.

2 Select the next display.



Name to give	display
Song title	Track Name
group name	GroupName
Disk name	Disc Name

3VOL +, - Turn the knob to select a character
 Then press the jog lever to decide. The selected character lights up to confirm. The cursor blinks at the next character position you have determined.

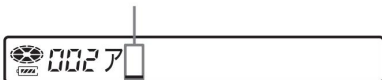
The cursor flashes at the next position.



The buttons and functions used for character input are as follows.

function	operation
Move the character cursor left or right.	Move the jog lever to. Or > to the side.
Change the character character by character.	Turn the rotary knob (VOL +, -).
Determine the character. Press the jog lever.	
Confirm the name. Press the jog lever for at least 2 seconds .	
Switch in the order of Kana ÿ Alphabet ÿ Numbers and symbols.	Press P MODE  .
When entering katakana, you can select characters in the order of "a"-> "ka"-> "sa"-> "ta".	Keep turning the rotary knob (VOL +, -).
Insert a space for one character before the cursor .	 Press +.
Delete the character on the cursor.	 -Press.
Stop entering characters. Press x for 2 seconds or longer.	

4 Repeat step 3 to give a name.

5 Press the jog lever for at least 2 seconds.

Rename

Follow the steps in "Name" (pages 50 and 51) to change the name. When you change the disc name, you can change it in any of the recording, playing, and stopped states. When changing before a song, make the change while the song is playing or stopped and the song is selected.

If you want to stop the setting in the middle, press x for 2 seconds or longer.

Press x to return to the previous setting .

please note

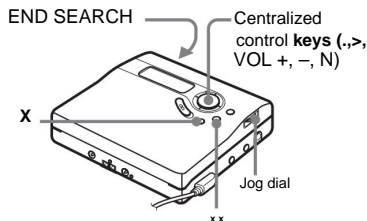

- If you display the title entered in kana on a minidisc device that does not support kana display, it will be displayed in romaji. At that time, "A" is added at the beginning and end.
- This unit cannot rewrite song titles, group names, or disc names that have more than 200 characters and are assigned by other devices .

Operate with the main body



Give a name

- Select "EDIT" — "Name" from the menu operation.
- Turn the jog dial to display the next display, and press to confirm.

Name to give	display
Song	 : Name
name Group name	 : Name
Disk name	 : Name

The cursor flashes in the input area and you are ready to enter characters.

The cursor blinks

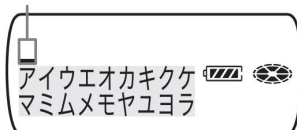

3 Press VOL -.

The cursor moves and blinks alternately with the letters.

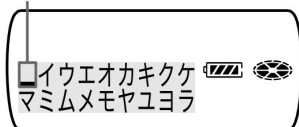

4 Select a character with the centralized control key

Press N to confirm. The

character selected in the character palette is displayed

in the input area, and the cursor blinks at the next

character position.

Flashes at the next position

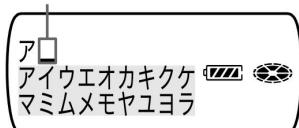

The buttons and functions used for character input are as follows.

Function *	operation
------------	-----------

Move the cursor on the character palette.	• Press the centralized control key.
---	--------------------------------------

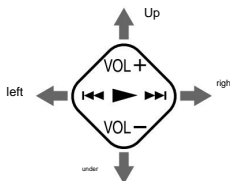

• Turn the jog dial (up / down movement only).

Select a character directly in the input area.	Turn the jog dial.
--	--------------------

Determine the character.	• Press N. • Press the jog dial.
--------------------------	----------------------------------

Move the cursor from the input area to the character pallet.	Press VOL -.
--	--------------

Move the cursor from the character palette to the input area.	Press x.
---	----------

Function *	operation
------------	-----------

Confirm the name. Press and hold N or the jog dial for at least 2 seconds.	
--	--

You can put a space for one character before the cursor .	Press END SEARCH and VOL + at the same time.
---	--

Delete the character on the cursor.	Press END SEARCH and VOL - at the same time.
-------------------------------------	--

Add voiced and semi-voiced sound marks to the characters on the cursor.	Press X.
---	----------

Symbols ; , - / are displayed.	Press X.
--------------------------------	----------

Switch between uppercase / lowercase letters of Alphabet on the cursor. Example: A ÿ a	Press X.
--	----------

Switch the kana character on the cursor to a sokuon. Example: Tsu y Tsu	Press X.
---	----------

Stop entering characters.	Press x when the cursor is in the input area .
---------------------------	--

* The button function is when the cursor is in the input area. And when it is in the character palette, it may be different.

5 Repeat step 4 to give a name.

6 Press the jog dial for 2 seconds or longer. The name will be entered.

please note

If the recording ends while you are inputting the song name or disc name during recording, or if the next song starts while you are inputting the song name during recording, the input up to that point is recorded. increase.

Rename Follow the

procedure in "Name" (pages 50-52) to change the name.

Change the song order (move)

Move songs

Example: When moving the 3rd song (C song) to the 2nd song

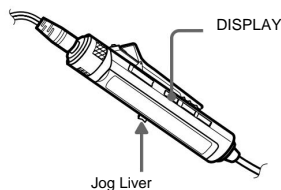
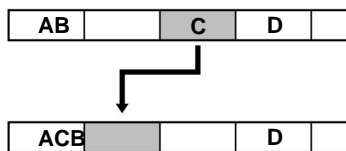

- 1 While playing the song you want to move, select "EDIT"-"Move"-"Track Move" from the menu operation. For example, when moving the third song, "y Tr003" is displayed in the display window.

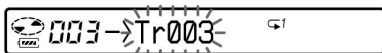

- 2 Move the jog lever to make the destination song blink. For example, when moving to the second song, "y Tr002" is displayed in the display window.

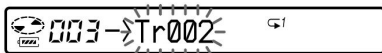

- 3 Press the jog lever to confirm.

To **stop in the middle**, press x for 2 seconds or longer.

Press x to **return to the previous setting**.

Move songs from a grouped disc

You can move songs that are not grouped or songs that are in a group to another group or group.

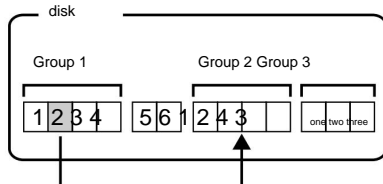

Move the 2nd song of Group 1 to the 3rd song of Group 2.

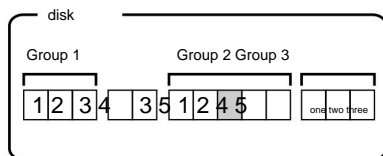

- 1 While playing the song you want to move, select "EDIT"-"Move"-"Track Move" from the menu operation.
- 2 If you want to move the song out of the group, go to step 3. To move a song to another group, shift the jog lever to display the destination group, and press to confirm.

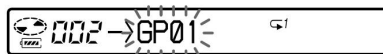

- 3 Move the jog lever to display the song number of the destination in the group (or the song number in the group when moving to the group), and press to confirm.

To stop the setting in the middle, press
x for 2 seconds or longer.

Press x to **return to the previous setting** .

Rearrange the order of groups (group move)

1 While playing a song in the group you want to move, select "EDIT" - "Move" - "Group Move" from the menu operation.

2 Move the jog lever to the place you want to move, and press it to decide.

Example) When moving the first group (GP01) to the second group (GP02)

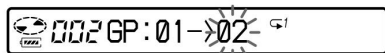

To stop the setting in the middle, press
x for 2 seconds or longer.

Press x to **return to the previous setting** .

Operate with the main body

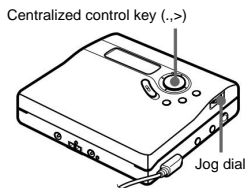

Move songs

1 While playing the song you want to move, select "EDIT" - "Move" - " : Move" from the menu operation. The song number flashes in the middle of the display window. If the song title has been entered, you can press> to display the song title . Press. To return to the song number.

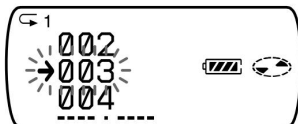

2 Turn the jog dial to display the song number of the destination. In the example, we want to move the C song to the second song, so turn the jog dial upward so that "002" flashes in the middle of the display window .

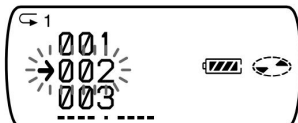

3 Press the jog dial to confirm.

The song you want to move to the specified position will move.

Move songs on a grouped disc

1 While playing the song you want to move, select "EDIT"->"Move"-> : Move" from the menu operation.

2 If you want to move the song out of the group, go to step 3. To move a song to another group, turn the jog dial to display the destination group, and press to confirm.

To.

If a group name has been entered, you can press> to display the group name. Press. To return to the group number.

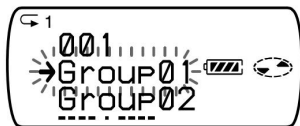

3 Turn the jog dial to display the song number of the destination in the group (or the song number in the group when moving to the group), and press to confirm. The song number flashes in the middle of the display window. If the song title has been entered, you can press> to display the song title. Press. To return to the song number.

Rearrange the order of groups (group move)

1 While playing a song in the group you want to move, select "EDIT"->"Move"-> : Move" from the menu operation. The number of the group containing the song being played flashes in the middle of the display window. If a group name has been entered, you can press> to display the group name. Press. To return to the group number. Example) When moving the first group (Group01) between the second group (Group02) and the third group (Group03)



2 Turn the jog dial to move it to the place you want to move, and press it to confirm.

To e

Divide the song (divide)

You can put a track mark in the middle of a song and move it to the next song. You can also fine-tune the position to divide the songs before dividing them. If you divide the songs, the song numbers will be as follows. It can be operated only on the main unit.

please note

Track marks cannot be added to songs transferred from a computer.

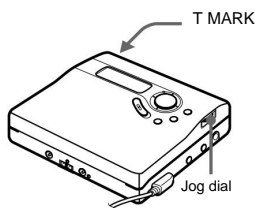
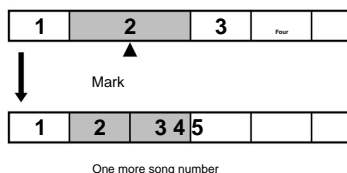

Divide songs directly (divide)

During playback or pause playback, press T MARK at the position you want to mark. "MARK ON" is displayed and the song number is incremented by one. From there it will be recorded as the next song.

Divide the song after adjusting the division position (divide rehearsal)

1 Press T MARK for 2 seconds or longer during playback.

From the point where T MARK is pressed, playback is repeated for 4 seconds.

Where T MARK was pressed

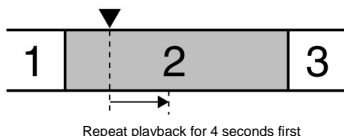

2 Turn the jog dial to adjust the point that divides the song. When you turn the jog dial, the points shift forward and backward. You can move it up to about 8 seconds from the position where you pressed T MARK in step 1.

Where T MARK was first pressed in step 1

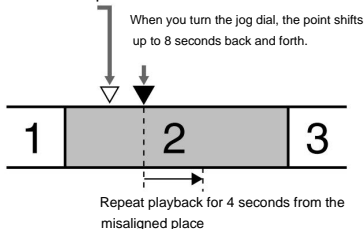

3 Press the jog dial to confirm.

To separate songs during recording

During recording (excluding synchronized recording), press T MARK (P MODE / on the remote control) at the position where you want to add a mark. You can also use the auto time mark to automatically separate songs at regular intervals (except during digital recording) (page 32).

Combine songs into one (combine)

When recording with analog input (LINE IN) or microphone input, an unnecessary track mark may be added to the part where quiet sound continues, and the song may be divided. In that case, you can remove the track mark to combine the songs before and after into one song. The song number is as follows. It can be operated only on the main unit.

please note

- Track marks cannot be erased for songs transferred from a computer.
- Songs and songs on the grouped disc

See page 47 for a single loop. • Songs recorded in different recording modes cannot be connected.

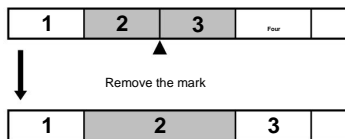

The song number is reduced by one

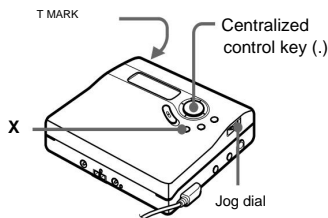

- 1 Play the song whose number you want to erase, and press X to pause the playback.

- 2 Press the. Of the centralized control key to move to the beginning of the song (00:00). For example, if you want to connect the 2nd and 3rd songs, put it at the beginning of the 3rd song.

"MARK" is displayed.

Press 3T MARK.

"MARK OFF" is displayed, and the specified song is connected to the previous song.

Z

The recording date and time and song title will be the first song of the two connected songs.

please note

If you connect two consecutive songs that belong to another group, the song will be registered in the group to which the previous song belongs. Also, if you connect consecutive songs that are not registered as a group, the song after that will be the same as the setting of the previous song.

To e

Erase the song (erase)

You can delete whole songs that you no longer need or songs on the disc.

please note

- Songs transferred from your computer cannot be deleted. Even if you erase the entire disc or the entire group, you cannot erase the songs transferred from your computer if even one song is included. ("Tr PROTECT" is displayed .) Return it to your computer and erase it.
- Once deleted, songs and groups cannot be restored. Please confirm the content of the song before erasing it.

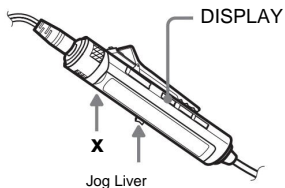

Erase one song

- 1 While playing the song you want to erase, select "EDIT"- "Erase"- "Track Erase" from the menu operation.
"Erase OK?" And "Push ENTER" are displayed .

- 2 Press the jog lever to confirm.

The song will be erased and the next song will be played. The song numbers after the erased songs are incremented one by one .

To erase a part of a song If

you want to erase only an unnecessary part such as a silent part, put a track mark at the beginning and end of the unnecessary part (page 56) and erase that part. **58**

Erase all songs

Erase all songs on the disc.

- 1 Play the disc you want to erase and then disc
Check the contents of.

- 2 Press x.

- 3 Select "EDIT"- "Erase" - "Disc Erase"
from the menu operation.
"All Erase?" And "Push ENTER" are
displayed .

- 4 Press the jog lever to confirm.

The "TOC Edit" display flashes and all songs are deleted. When the erasure is completed, "BLANK DISC" flashes and "00: 00" is displayed.

Erase the group

Deletes the group name and all songs in the group.

- 1 Select the group you want to delete ("To cue
a group (skip a group)" (page 39)) and
check the contents.

- 2 Press x.

- 3 Select "EDIT"- "Erase" - "Group Erase"
from the menu operation.
"Gp Erase?" And "Push ENTER" are
displayed .

- 4 Press the jog lever to confirm. The
group will be deleted.

To **stop in the middle**, press
x for 2 seconds or longer.

Press x to **return to the
previous setting** .

Operate with the main body

Once deleted, songs and groups cannot be restored. Please check the contents carefully before erasing.



Erase one song

- 1 While playing the song you want to erase, select "EDIT"->"Erase"->" : Erase" from the menu operation. The song title (or song number), "Erase OK?", And "Push ENTER" are displayed in the display window.

- 2 Press the jog dial to confirm.

The song will be erased and the next song will be played. The song numbers after the erased songs are incremented one by one .

Erase all songs

- 1 Play the disc you want to erase and then disc Check the contents of.

- 2 Press x.

- 3 While stopped, select "EDIT" from the menu operation.

-Select "Erase"->" : Erase"
Bu.

The disk name, "All Erase?", And "Push ENTER" are displayed in the display window.

- 4 Press the jog dial to confirm.

The "TOC Edit" display flashes and all songs are deleted. When the erasure is completed, "BLANK DISC" flashes and "00: 00" is displayed.

Erase the group

- 1 Select the group you want to delete ("To cue a group (group skip) " (page 39)) and check the contents.

- 2 Press x.

- 3 Select "EDIT"->"Erase"->" : Erase" from the menu operation. The group name and "GP Erase?" Light up in the display window, and "Push ENTER" flashes .

- 4 Press the jog dial to confirm.

To
edit

What you can do by connecting to a computer

Use the included software •

Transfer music data between this unit and your computer.

You

can use the included SonicStage software to exchange music data between this unit and your computer.

- Included MD Simple Burner software

to record songs directly from CD to MD

You can use the ware to record the CD in the CD drive of your computer directly to the disc of this unit.

For detailed explanation, refer to the separate "Installation / Operation Guide SonicStage Ver.2.0 / MD Simple Burner Ver.2.0 for MD Walkman" or Help.

Connect to computer

After installing the software, connect this unit to your computer. For the installation of software, refer to the separate "Installation and Operation Guide SonicStage Ver.2.0 / MD Simple Burner Ver.2.0 for MD Walkman" .

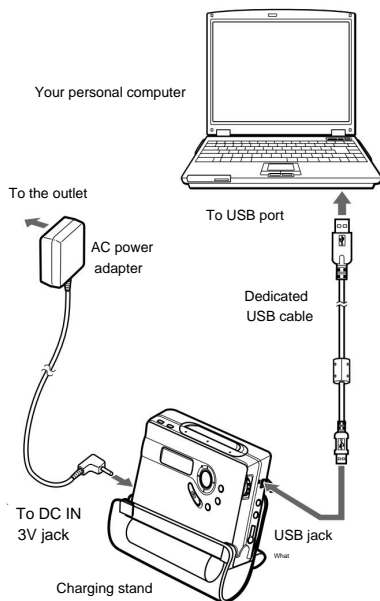

1 Insert a recording disc into the main unit.

2 Connect the main unit, PC, and AC adapter as follows . 1 Insert a charged rechargeable battery.

2 AC power adapter is rechargeable

Connect to Tando. 3

Dedicated USB that comes with the main unit and PC

Connect with a cable.

4 Stop the main unit, release the hold, and place it on the charging stand.

3 Confirm that the connection is correct.

When connected correctly , "PC >> MD" will be displayed in the display window of the remote control **and** "PCccMD " will be displayed in the display window of the main unit .

Remote control display window

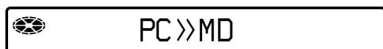

Display window of the main body

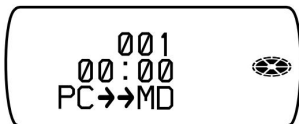

please note

When connecting to a computer, we recommend connecting this unit to an AC power adapter and using it with a household power supply. When using with batteries, make sure that the batteries are fully charged (rechargeable batteries are fully charged). Please note that we do not guarantee any malfunction due to insufficient battery power, failure to transfer music data, or destruction of music data.

Set the clock

If you set the clock, the recording date and time will be recorded automatically when recording. The recording date and time will always be recorded once the clock is set. The recording date and time is not recorded for songs transferred from your computer. It can be operated only on the main unit.

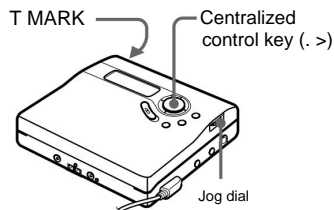

1 While stopped, by operating the menu

Select "OPTION"->"CLOCK SET"

Bu.

The year number flashes.

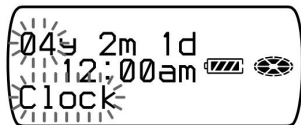

2 Turn the jog dial to set the year and press to confirm.

The number of the month flashes.

3 Repeat step 2 to set the month, day, hour, and minute. Set the minute and press the jog dial to start the clock from 0 seconds.

If you make a mistake on the way, press. To return to the previous item and reinsert it. For numbers that do not need to be changed, press> to proceed. 62

To display the current date and time •

On the main unit, select "DISPLAY"->"Clock"

from the menu operation while stopped or recording .

• On the remote

control, press DISPLAY repeatedly while stopped or recording .

To change the clock to 24-hour display, press

T MARK while setting the clock. Press it again to return to the 12-hour display.

Once the clock is set to keep the clock settings, the clock settings will be retained as long as the AC power adapter , rechargeable battery, or battery is connected. However, if you do not connect any power supply , the clock settings will return to the default settings in about 3 minutes. Please replace the batteries within 3 minutes.

stomach.

please note

- If you want to record the recording date and time for a particularly important recording, display the current date and time and check that the clock is set.
- There may be an error of about 3 minutes a month.

vinager.

Turn off the confirmation sound

You can set whether to sound the confirmation sound of the main unit / remote control or not.

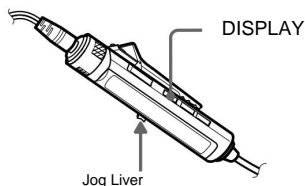

1 Menu operation "OPTION"-

Select "BEEP".

- 2 Shift the jog lever, select "BEEP OFF", and press to confirm.

To restore the settings, select "BEEP ON" in step 2.

Operate with the main body

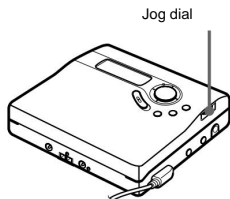

1 Menu operation "OPTION"-

Select "BEEP".

- 2 Turn the jog dial to select "BEEP OFF" and press to confirm.

Change the movement of the jog dial

By default, turning the Jog Dial downwards scrolls the display screen downwards, but you can change this in the opposite direction. It can be operated only on the main unit.

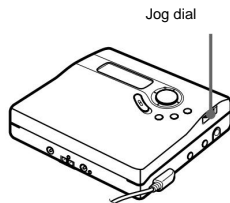

- 1 Select "OPTION"- "JOG DIAL" from the menu operation.

- 2 Turn the jog dial
Select "REVERSE" and press to confirm To.

To restore the settings, select "DEFAULT" in step 2.

various

Record without overwriting

You can change the recording start position to always record from behind the recorded part without overwriting. At the time of purchase, it is set to record by overwriting. It can be operated only on the main unit.

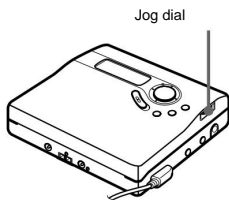

1 While stopped, by operating the menu

Select "OPTION"-"REC-Posi"
Bu.

2 Select "From End" with the jog dial
And press to decide.

To restore the settings, select "From Here" in step 2 .

Z

- If you do not want to temporarily overwrite the recording even if the recording start position is set to "From Here", you can start recording by pressing the END SEARCH button to start recording from behind the recorded part. I can do it. Also When you press the END SEARCH button, the remaining recording time is displayed. • When recording, if the group recording (" : REC ON") setting is set to always be a group (" : REC ON"), it will always be the "From End" setting (pages 34 and 35).).

Listen to the sound quickly (quick mode)

After pressing the play button or cueing a song, you can quickly hear the playback sound.

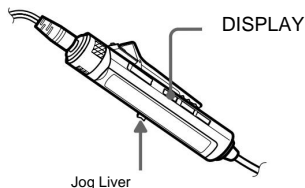

1 While stopped or playing, select
"OPTION"-"Power Mode" from the menu
operation .

2 Use the jog lever to shift and select
"QUICK" , then press to confirm.

To restore the settings, select "NORMAL" in step 2.

please note

- When the setting is set to "QUICK", the power is always on inside the main unit even when nothing is displayed on the screen. Therefore, the battery life will be shortened, so it is recommended to charge it every day.
- If no operation is performed (including opening / closing the lid) and 17 hours have passed, the power inside the main unit will automatically turn off. The next operation will be slower, but after that it will be in quick mode again.

Operate with the main body

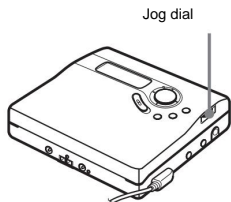

- 1 While stopped or playing, select "OPTION"- "Power Mode" from the menu operation .
- 2 Turn the jog dial to select "QUICK" and press to confirm.

Reduce battery consumption

It is a function that reduces battery consumption and maximizes the duration. Immediately after the operation, turn off the display on the main unit and remote control.

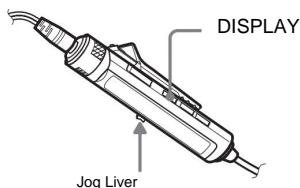

- 1 Select "OPTION"- "Power Mode" from the menu operation .

2 Shift the jog lever

Select "Power Save" and press to confirm.

To restore the settings, select "NORMAL" in step 2.

Operate with the main body

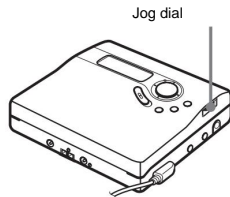

- 1 Select "OPTION"- "Power Mode" from the menu operation .

2 Turn the jog dial

Select "Power Save" and press to confirm.

Suppresses sound leakage and makes the sound easy on the ears (AVLS-auto volume limiter-system-comfortable volume)

You can listen at a more comfortable volume by reducing the risk of sound leakage due to excessive volume increase, pressure on your ears, and inability to hear surrounding sounds.

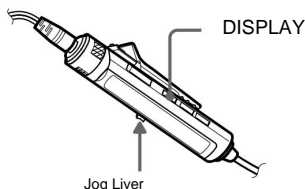

1 Menu operation "OPTION"-

Select "AVLS".

- 2 Shift the jog lever, select "AVLS ON", and press to confirm. If you try to raise the volume above a certain level, "AVLS" will blink in the display window and the volume will not increase any further.

To cancel the setting,

select "AVLS OFF" in step 2.

Operate with the main body

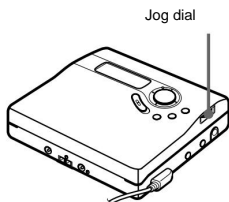

- 1 While stopped or playing, select "OPTION"- "AVLS" from the menu operation.
- 2 Turn the jog dial to select "AVLS ON" and press it to confirm.

Turn on / off the backlight of the display window

You can set the display window of the remote control to be always on / not turned on. It can be operated only with the remote control.

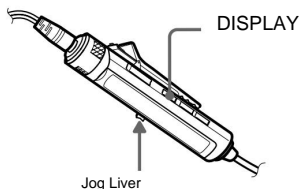

- 1 While stopped, select "OPTION"- "BACKLIGHT" from the menu operation.
- 2 Select the setting you like.

Display settings

AUTO	Lights during operation. It goes out after a few seconds without doing anything.
ON	Always lit when moving.
OFF OFF	Always off.

View the titles of Chinese characters entered on a computer, etc. window (contrast adjustment)

If you use the included software SonicStage / MD Simple Burner to enter kanji or hiragana characters on your computer, you can display them on the remote control of this unit. There are two types of display. • Kanji priority: Purchase settings. Normally, leave it here. • Alternate Kanji and Kana: Enter characters on your computer

Select this when you have registered different information in the full-width area and the half-width area (example: song title in the full-width area, artist name in the half-width area, etc.). Both information is displayed.

It can be operated only with the remote control.

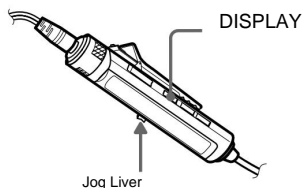

To set to "Kanji Kana Alternate"

- 1 Select "OPTION"- Select display method" from the menu operation.
- 2 Select "Kanji Kana Alternate".

please note

On this unit, even if characters are entered in full-width characters using computer software, all alphanumerical characters and spaces are displayed in half-width characters.

Adjust the shade of the display window (contrast adjustment)

You can adjust the contrast of the LCD display on the main unit. It can be operated only on the main unit.

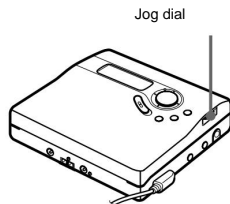

- 1 While stopped, blink "OPTION"- "CONTRAST" by menu operation and press to confirm.
- 2 Turn the jog dial to select the shade of the display window and press it to confirm.

Note

contrast of the display window of the remote control cannot be adjusted.

Sound an alarm (melody timer)

It is convenient to prevent passing by trains . Please choose one from three types of alarms . You can set the time until the alarm sounds from 1 minute to 99 minutes. The melody timer works even when it is stopped.

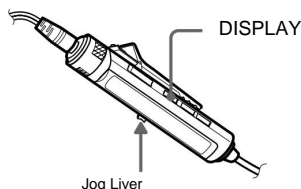

1 Menu operation "USEFUL"-

Select "Melody Timer"-"ON". , Will light up.

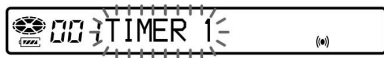

2 Move the jog lever to. Or > to select the alarm type and press to confirm.

display	Sound type
TIMER 1 Melody (Arlésienne)	
TIMER 2 melody	(Canon of Pachelbel)
TIMER 3 melody	(For Elise)

3 Move the jog lever to. Or> to select the time until the alarm sounds.

Bu.

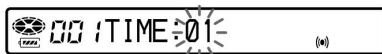

Every time I shift the jog lever "TIME: 01" to "TIME: 99" (1 minute to 99 minutes) are displayed and can be set in 1 minute increments.

4 Press the jog lever to confirm.

The melody timer is set. When stopped, the time until the sound is heard is displayed.

If you want to stop the setting in the middle, press x for 2 seconds or longer.

Press x to **return to the previous setting** .

To check the time until the alarm sounds , stop playback. After a while, the time until the sound is heard is displayed. If playback is in progress or playback is paused, repeat steps up to step 3 to display it.

To cancel the reservation, select "OFF" in step 1.

Press any button **to stop the alarm** .

Z

- When you finish the operation in step 1, the timer is set with the same settings as last time. • The alarm will sound for 1 minute and then the setting will be cleared.

If the sound stops while it is stopped, the power will turn off in about 10 seconds. If the sound finishes during playback, playback will continue.

please note

- When you start recording, the setting will be canceled.
- When you select "ON" in step 1, the timer starts counting. Also, when you change the time until the sound is heard in step 3, try the count again.

Operate with the main body

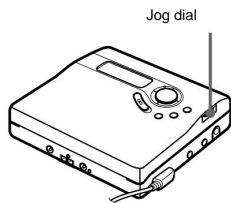

- 1 Select "USEFUL"- "M-TIMER"- "ON" from the menu operation. , Will light up.
- 2 Turn the jog dial to select the alarm type and press to confirm. See step 2 on page 68 for alarm types .
- 3 Turn the jog dial to select the time until the alarm sounds. Every time I turn the jog dial "TIME: 01" to "TIME: 99" (1 minute to 99 minutes) are displayed and can be set in 1 minute increments.
- 4 Press the jog dial to confirm.
When stopped, the time until the sound is heard is displayed.

Store settings for each disk (personal disk memory)

Register the disk setting information in the main unit. If you insert the registered disk again, the setting information will be recalled automatically. The following setting information can be registered. • Volume • Playback mode • Group mode • Program playback • Sound quality (virtual surround / 6- band equalizer) • Playback speed (digital pitch control)

- Le)
• Bookmark

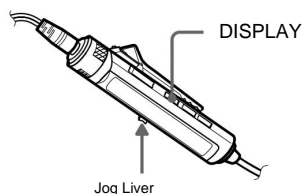

- 1 Select "USEFUL"- "PERSONAL" from the menu operation while stopped, playing, or pausing .
"Entry?" Flashes.
- 2 Press the jog lever to confirm.
"Entry OK" is displayed and the setting information of the current disk is registered.

various

To unregister

1 Insert the disc you want to delete from the registration and check the contents.

2 After step 1 above, select "Erase?".

"Erase OK" is displayed and the disk setting information is deleted from the registration.

please note

If you perform this operation on an unregistered disc, "No Entry!" Will be displayed.

Z

When you insert the disc registered in the personal disc memory again, "PERSONAL" is displayed .

please note

- You can register up to 20 discs, but if you exceed 20 discs, the oldest ones will be automatically deleted. • Once you edit a registered disc (excluding name editing) or record it, it will be recognized as another disc and the registered information will be invalid. In that case, please register again.

Operate with the main body

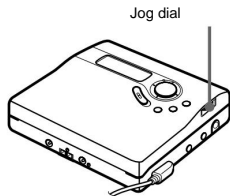

1 Select "USEFUL"- "PERSONAL" from the menu operation while stopped, playing, or pausing .

"Entry?" Flashes.

2 Press the jog dial to confirm.

Precautions for use

Do not disassemble

It is dangerous if the laser used in the MiniDisc recorder hits your eyes.

Do not touch the lens. If the lens becomes dirty, skipping may occur or playback may not be possible. Also, be sure to keep the lid closed except when inserting and removing the disc to prevent dust from getting on.

About AC power adapter

• Use the included AC power adapter (unified polarity plug, JEITA standard) for this product. Using a product other than the above may cause a malfunction.



Polarized unified plug

- Connect the AC power adapter to a power outlet that is easily accessible, and disconnect it immediately if something goes wrong.
- Please note the following points when using the AC power adapter. — Do not place the unit in a small space such as a shelf or a built-in cabinet. — To avoid the risk of fire or electric shock, do not use in wet or damp places. Also, do not place anything containing water, such as a vase, on the machine.

Disposal of rechargeable batteries in Japan



Ni-MH

Nickel-metal hydride batteries can be recycled. If you no longer need a nickel-metal hydride battery, attach insulating tape such as cellophane tape to the metal part and take it to a recycling partner store.

For inquiries regarding the collection / recycling and recycling of rechargeable batteries, please refer to the Battery Industry Association website <http://www.baj.or.jp/>.

Handling

- Do not drop or give a strong shock. It may cause a malfunction.
- Do not pull the cord of the remote control or headphones strongly.
- Do not place in the following places. — Where the temperature is very high (60 ° C or higher). — In direct sunlight or near a heater

nine.

— Inside a car with the windows closed (especially in the summer). — A humid place such as a bathroom. — Near magnetic objects such as magnets, speakers, and televisions. — A place with a lot of dust.

- The LCD display may be difficult to see or the display may change slowly at high temperatures (40 ° C or higher) or low temperatures (0 ° C or lower). When it returns to room temperature, it will return to its original state.
- Do not put hard objects in the carrying pouch together with the main body. It may cause paint baldness or scratches.
- Do not remove or disconnect the disk while reading or writing. It may not be recorded all the time, or the recorded music data may be lost.
- If you use the product in a place affected by static electricity or electrical noise, it may not be recorded properly or the recorded music data may be lost.

Temperature rise

The temperature of the main unit may rise during charging or when it is used for a long time, but this is not a problem.

Operation sound

This unit uses a power-saving operation method. Therefore, there is an intermittent operating noise during operation, but this is not a malfunction.

Charging • The

included charging stand is for this unit only. Other devices cannot be charged. • Use the supplied charging stand to charge only the specified batteries.

- Charge the battery in a place between + 5 ° C and + 40 ° C. when.
- While charging, the charging stand and the main unit will become hot, but there is no danger. • Replace the rechargeable battery with a new one when it is fully charged and the usable time is reduced to about half of the normal time. • If you will not be using the product for a long time, unplug the AC power adapter from the outlet and disconnect the main unit from the charging stand.

Handling of the disc • The disc itself is stored in the cartridge and is stored in the cartridge.

It is easy to handle without worrying about dust and fingerprints. However, dirt or warpage of the cartridge may cause malfunction. Please note the following so that you can enjoy beautiful sounds forever. — Do not touch the internal disc directly

Do not open the shutter by hand. If you force it open, it will break.

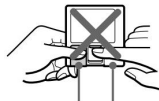

Shutter cartridge

— Put it in a case when you carry it or store it — Where to put it

Do not place in places with high temperature or high humidity such as in direct sunlight. Also, do not leave the disc in a place where sand may get inside, such as a sandy beach. — Clean regularly Wipe off any dust or debris on the surface of the cartridge with a dry cloth. • Do not put the label attached to the disc in any position other than the specified position. Be sure to attach it firmly according to the indentation for the label.

Headphones • If you feel that the

supplied headphones do not fit your skin, stop using them as soon as possible and consult a doctor or customer service center. • If you turn up the volume of the included headphones too high, the sound will leak out. Be careful not to turn up the volume too much and disturb the people around you. It is easy to turn up the volume in a noisy place, but when listening with headphones, use a volume that is sufficient to be called and answered at any time.

About the remote control The

attached remote control is for this unit only. Also, you cannot operate this unit with the remote control that comes with other models.

About the dry battery case The

attached dry battery case is for this unit only.

Cleaning If the surface

becomes dirty, wipe it gently with a soft cloth dampened with water and then wipe it off. Do not use thinner, benzene, alcohol, etc. as they will damage the surface.

Cleaning the headphone and remote control plugs Dirty plugs may cause noise or interruptions in sound. Keep the plug clean by occasionally wiping it with a soft cloth to ensure a good sound at all times.

Cleaning the terminals

Regularly clean each terminal with a cotton swab or a soft cloth.

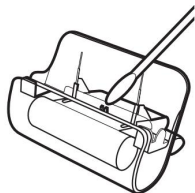

Accidental Erase Prevention Knob

To prevent accidental erasure of recorded recordings, shift the accidental erasure prevention knob to leave a hole in the recording. If you move the knob to make a hole, you will not be able to record or edit. Close the knob when recording / editing.

The back of the disc

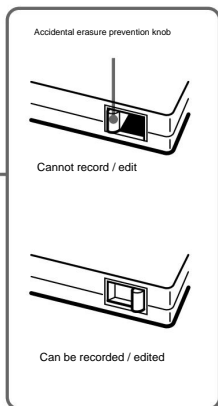

In the unlikely event that the product breaks down, do not open the inside and contact the store where you purchased the product or a Sony service center. (If the product breaks down while it is in the main unit, we recommend that you consult with us with the disc inserted in order to resolve the cause of the failure as soon as possible.)

Main Specifications

format

Minidisc Digital Audio System

Recording

method Magnetic field

modulation Optical method Reproduction

reading method Non-contact optical reading (using semiconductor laser)

laser

GaAlAsMQW diode, $\lambda = 790\text{nm}$

Recording / playback time (when

using MDW-80) Monaural maximum 160 minutes

Stereo maximum 320 minutes

Rotation

speed approx. 350 rpm to 3600 rpm (CLV)

error correction method

ACIRC (Advanced Cross Interleaved Solomon Code)

Sampling frequency 44.1kHz

Sampling rate converter

Input: 32 kHz / 44.1 kHz / 48 kHz

Coding ATRAC (Adaptive Transform

Acoustic Coding) ATRAC3 — LP2 / LP4

Modulation method

EFM

Frequency characteristics (at the time of optical digital / analog

input) 1)

20-20,000 Hz ± 3 dB

Input terminal 2)

MIC: Stereo mini jack

(Minimum input level 0.25

mV) LINE IN: Stereo mini jack for analog

(Minimum input level 49 mV) Optical mini jack for optical digital

various s

Output terminal

i / LINK OUT3): Stereo mini jack (dedicated remote control jack) / specified output 123 mV (10 kV)

Practical maximum output (at DC) 4)

Headphones: 5 mW + 5 mW (16 V)

power supply

Rechargeable NiMH Battery

NH-14WM (A) 1.2 V, 1350 mAh (MIN) Ni-MH 1

Alkaline Battery (AA) 1 AC Power Adapter DC 3V, AC

100V, 50/60 Hz battery life 4)

See "Battery duration" (page 20)

Body dimensions

Approximately 78.9 x 72.2 x 15.9 mm
(width / height / depth, excluding protrusions)

Maximum external dimensions 4)

Approximately 80.6 x 74.2 x 21.0 mm
(width / height / depth)

mass

Approximately 94g (main unit only)

Approximately 121g (including rechargeable battery)

1) Headphone output 2)

Input (optical digital) and input (analog) can be used for both purposes.

Cook

3) Headphones and LINK OUT are dual-purpose jacks

4) Measured values according to JEITA (Japan Electronics and Information Technology Industries Association) standards

is.

This machine is a licensed product based on US and foreign patents of Dolby Laboratories.

Please note that the specifications and appearance of this machine are subject to change without notice for improvement.

atomach.

Optional accessories

Optical digital cable

Optical square plug y Optical mini plug

POC-5 / 10 / 15AB

Optical Mini Plug y Optical Mini Plug

POC-5 / 10 / 15B

Optical mini plug (on / output) yL type 7 -pin connector POC-DA12SP Connection cord

(analog) Stereo mini plug y pin plug (x 2) RK-G129

Stereo mini plug y Stereo mini plug RK-G136

Car connecting pack CPA-81) Car battery

cord DCC-E2301) Stereo microphone ECM-719,

ECM-MS907, ECM-MS957

Stereo Headphones 2) MDR-EX70SL, MDR-E888SP

Active speaker SRS-Z510 / Z30 etc. Minidisc (raw disc) ES series

MD Soft Carrying Pouch MD-4SCPL / N

Rotary Commander RM-WMC1,

MD label printer MZP-1, IC memory, repeat learning, MD controller

RPT-M1 cannot be used.

1) Please connect directly to the main

body. 2) Please purchase headphones with a stereo mini plug. Micro plugs cannot be used.

Is it a malfunction? If you think

If you encounter any trouble while using this machine, please check again according to the following flow before consulting with the service center. (See also the message list (page 83).) If a message is displayed, it is recommended that you write it down.

Step 1 Check this

"Troubleshooting" in this manual and check the applicable items. You can also find various information in the procedures in this manual and in the "Message List". Check the applicable item.

m

Step 2 Check the homepage of "Personal Audio Customer Support" Check <http://www.sony.co.jp/support-pa/> . It contains the latest support information, frequently asked questions, and answers.

m

Step 3 If the problem still persists, please contact the Customer Support Center (back cover) or the store where you purchased the product.

Trouble
TSU

Tokin

About charging

Symptoms	Cause	measures
Cannot be charged or cannot be fully charged.	The rechargeable battery or dry battery is not inserted correctly. Or the AC power adapter is not connected properly.	Correctly reinsert the e and E terminals of the rechargeable battery or dry battery . Or connect the AC power adapter correctly.
	The charging terminal of the charging stand is dirty.	Wipe the charging terminal with a dry cloth.
	The duration may be short due to the characteristics of the battery when it is purchased or when it has not been used for a long time.	After repeating charging and discharging several times, it will be fully charged.
	The rechargeable battery is exhausted (the charging lamp does not light even at the charging stand).	Please charge. Charging will start in about 1 minute . If charging still does not start, remove the main unit from the charging stand, insert the rechargeable battery again, and then put the main unit back on the charging stand.
	The temperature at the charging location is too low or too high ("Cannot CHG" is displayed).	Charge the battery in a place between + 5 ° C and + 40 ° C.
The rechargeable battery has run out even though I wasn't using it.	The quick mode setting was "QUICK" (page 64).	When the quick mode setting is set to "QUICK" , the power is always on inside the main unit even when nothing is displayed on the screen. Therefore, the battery life will be shorter. If the battery is not fully charged and the setting is "QUICK", the rechargeable battery may be consumed while it is not in use. In that case, charge it again.
Even if it is fully charged, it can only be used for about half the normal time.	It may be the battery life. Replace with a new rechargeable battery	when.
The main unit and charging stand become hot during charging.	This is not a malfunction.	---



Recording

Symptoms	Cause	measures
Overwritten recording.	The recording start position setting ("REC Posi") is set to "From Here".	Set the recording start position setting ("REC Posi") to "From End " (page 64).

Symptoms	Cause	measures
Even though the "REC-Posi" setting is "From Here", recording starts from the end of the disc.	The group recording (REC) setting is set to always be a group (" : REC ON").	Set " : REC" in the menu to " : REC OFF" (page 35).
The "REC-Posi" setting cannot be set to "From Here".	The group recording (REC) setting is set to " : REC ON".	Set " : REC" in the menu to " : REC OFF", and then Set "REC-Posi" to "From Here".
I can't record.	Not properly connected to the sound source.	Please reconnect (pages 21 and 36). Connect a portable CD player to a household power supply and have a skip guard function
	There is no digital output from the portable CD player.	Please turn off (ESP, etc.).
	A connection cord with a resistor is used (during analog input recording).	Use a connection cord that does not contain resistance.
	The recording level is too low (during manual tuning). The power was unplugged or there was a power outage during recording.	Adjust the recording level (page 31). The contents of the recording up to that point have disappeared. Please re-record from the beginning.
	Contains a play-only disc. Replace it with a recording disc when.	
	The remaining time of the disc is 12 seconds or less, and it has been replaced with another recording disc ("DISC FULL" is displayed).	
Recording stops on the way.	I tried to overwrite the disc containing the songs transferred from my computer. (Songs transferred from a computer cannot be overwritten. Recording will end automatically.)	Please return the transferred song to your computer before recording. Start recording from the end of the disc without overwriting.
While recording in monaural, you can hear it in stereo from the headphone.	During digital recording, you can hear it in stereo through headphones. (The recorded sound will be monaural.)	--
Momentary noise is generated during recording.	In LP4 stereo recording, due to the characteristics of the compression method, momentary noise is generated very rarely depending on the sound source of the recording source.	Do stereo recording or LP2 stereo recording.
The lid does not open after recording.	After recording , do not open the lid until the "TOC Edit" display disappears.	--

	Cause	measures
Symptom Even if the maximum recordable time (60 minutes, 74 minutes, 80 minutes) has not been reached, "TR FULL" is displayed and recording cannot be started.	It is a system constraint. Once 254 songs have been recorded, no further recordings will be possible (page 93).	To add more songs, erase unnecessary songs and record.
Erasing a song does not increase the remaining recording time on the disc.	It is a system constraint. For short songs, the remaining time that can be recorded may not increase even if some songs are erased (page 93).	--
The total recording time and remaining time on the disc does not match the maximum recordable time (60 minutes, 74 minutes, 80 minutes).	It is a system constraint. Recording is done in seconds, so recording a lot of short songs will increase the so-called "wasteful" recordings, which will not match the total time (page 93).	--
Even though there are plenty of songs and recording time, "TR FULL" is displayed and recording stops.	It is a system constraint. This is probably because the recording and erasing were repeated on the same disk (page 92).	To add more songs, erase unnecessary songs and record.

Playing

	Cause	measures
Symptoms Normal regeneration is not possible. Repeat playback is specified. Use the jog dial on the main unit, and press the P MODE / button on the remote control for 2 seconds or longer to turn off the (repeat) display before starting playback (pages 38 and 40). Use the jog dial on the main unit and press P MODE on the remote control to return to normal playback before starting playback (pages 38 and 40).	I changed the playback mode.	 
Do not play from the first song on the disc.	When I played it last time, I stopped in the middle of the disc. Registered in personal disk memory.	Stop it once, and press and hold N on the main unit and the jog lever on the remote control for 2 seconds or longer. Delete it from the personal disk memory (page 70).
The sound is interrupted during playback. Place it in a place with a lot of vibration. Please use in a place with less vibration.		 The recording time of one song is extremely short. Do not make short tracks (songs) (page 92).
There is a lot of noise.	Place it near a strong magnetic object such as a TV.	Keep it away from TVs.

Symptom When playing a recorded song, the sound is low.	Cause Recorded in analog. (In the case of digital recording, it is automatically recorded at the same level as the recording source.) Alternatively, recording was performed using a connection cord with a resistor (sold separately, RK-G128 / RK G134, etc.).	Countermeasure Use the correct connection cord (sold separately, RK G129 / RK-G136, etc.).
	The recording level was low.	Manually adjust the recording level to record (page 31).
The sound does not get louder. AVLS is working		Cancel the AVLS setting (page 66). Adjust the volume (page 24).
There is no sound from the headphones.	The volume is low.	
	Headphones with remote control are not plugged in firmly.	Insert it firmly into the i / LINK OUT jack. Insert the headphone plug firmly into the remote control unit.
	The plug is dirty.	Wipe the plugs of the headphones and remote control with a dry cloth.
The volume cannot be adjusted, there is noise, or the virtual surround and 6- band equalizer do not work.	The i / LINK OUT output ("AUDIO OUT") setting is set to "LINK OUT" .	Set the i / LINK OUT output ("AUDIO OUT") to "Head Phone" . Alternatively, connect headphones with a remote control.
When I make an analog connection and listen to the sound from a speaker or amplifier, the sound is quiet.	The i / LINK OUT output ("AUDIO OUT") setting is set to "Head Phone" .	Set the i / LINK OUT output ("AUDIO OUT") to "LINK OUT" (page 45).
When I connect headphones, the sound is loud.	The i / LINK OUT output ("AUDIO OUT") setting is set to "LINK OUT" .	Set the i / LINK OUT output ("AUDIO OUT") to "Head Phone" . Alternatively, connect headphones with a remote control.
When fast-forwarding or fast-rewinding on the main unit, some songs are skipped to the previous or previous song. If you fast forward and fast rewind while playing the edited song, the sound will be interrupted.	The group skip function is working. It is a system constraint. When fast-forwarding or rewinding while playing, the sound may be interrupted because the sound is played at a higher speed than usual (page 92).	If you wait for 5 seconds or more without any operation, the group skip will be canceled automatically. ---
When I replay what I recorded using a radio cassette player or an amplifier, or when I play it back with a radio cassette player or an amplifier connected, one of the sounds does not come out.	When connecting to a radio cassette player or amplifier using a monaural cord, one (R CH) sound does not come out.	Be sure to use a stereo chord. If the connected device uses monaural, one (R CH) sound will not be output even if you use a stereo cord .

While editing

Symptoms	Cause	
The lid does not open.	The power was removed or the battery was exhausted during editing.	Countermeasures Turn the power off and then on again to charge the battery, or replace it with a new battery.
Cannot be edited with this machine.	The power was unplugged or there was a power outage during editing.	The edited contents up to that point have disappeared. Please try again.
I can't erase the songs transferred from my computer.	It is a system constraint. Return the songs transferred from your computer to your computer and use SonicStage to erase them.	--
I can't erase the song number.	It is a system constraint. If the data of the song to be connected is short, it may not be possible to delete the track mark (song number) of that song and connect it to the previous song. Also, track marks between songs recorded in different recording modes can not be erased (page 93). You tried to edit on a device that does not support the stereo long-time recording mode.	--
Cannot be edited on other models.		Edit with this unit or another device that supports the stereo long-time recording mode.

During group function

	Cause	
Symptoms Group function does not work.	There is a disk that has not been set as a group.	Countermeasure Insert the disk for which the group is set.
New group cannot be recorded / Cannot set new group.	It is a system constraint. If the total number of characters entered exceeds approximately 1700 characters, recording in groups will not create a new group. Also, when I try to set a group, I cannot do it (page 94).	--

Other general

	Cause	measures
Symptoms The operation is not accepted or does not work properly.	The rechargeable battery is not charging. Please charge.	
	The volume is low.	Turn up the volume.
	There is no disc in it.	Insert a pre-recorded disc.



Symptoms	Cause	
It does not accept operations or does not work properly.	The hold function is working ("HOLD" is displayed when you press the operation button on the main unit).	Countermeasure Set the HOLD switch in the opposite direction of the arrow to cancel the hold function (pages 14 and 19).
	The lid is not closed tightly.	Close the lid until you hear a click.
	Condensation (water droplets adhere to the inside).	Remove the disc and leave it for a few hours.
	The AC power adapter is not firmly inserted.	Plug it firmly into the DC IN 3V jack and outlet.
	The battery is dead ("LOW BATT" display flashes or nothing is displayed).	Charge or replace the batteries with new ones (pages 18 and 19). Or connect the AC power adapter.
	The batteries are not inserted correctly.	Reinsert the e and E terminals of the batteries correctly (page 19).
	It contains a damaged disc or a disc that does not contain correct information such as recordings and edits.	Reinsert the disc or re-record. If the error display still appears, replace it with another disk.
	The internal system is malfunctioning. Install after restarting the computer	please.
The clock does not move correctly / The clock display does not appear (-y --m--d) / The recording date and time is not recorded.	During use, it receives strong noise due to shock, excessive static electricity, abnormal power supply voltage due to lightning, etc.	Follow the procedure below again. 1 Remove all power supplies. 2 Leave it for about 30 seconds. 3 Connect the power supply.
	The rechargeable battery was completely exhausted, and no other power supply was connected for more than 3 minutes, so the default settings were restored.	Connect the AC power adapter to an outlet to charge the battery, and set the watch (page 62).
	I haven't set the clock.	Set the clock (page 62).
	The recording date and time are not recorded for songs transferred from a computer.	--
The display window of the remote control does not light during playback.	The power save function is working. When the power save function is working, the display window	lights up when you operate it with the remote control, but the display window of the remote control does not light up even if you operate it with the main unit. (However, it lights only when the GROUP button on the main unit is pressed.)
The liquid crystal display is different from the normal display.	I unplugged the power.	Leave it for a while. Or turn on the power and press one of the operation buttons.







Cause	
Symptom When using with the AC power adapter, the display window is shining faintly for a while even after it is stopped.	Countermeasure This is a system constraint. In order to accumulate the charging time at the charging stand, the power is supposed to be turned off 3 minutes after the stop. --
The playing time of the song transferred from the computer does not match the playing time on the computer.	It is a calculation error between the main unit and the personal computer. --
I can't transfer songs from my computer to the full recordable time of the disc. (Example: For an 80-minute disc I can't transfer 160 minutes with LP2 stereo recording .)	It is a system constraint. Recording is done in seconds, so recording a lot of short songs will increase the so-called "wasteful" recordings, which will not match the total time (page 93). --

Message list

If you see a message in the display window of the main unit, please check it according to the table below.

display	meaning	measures
 FULL	I tried to bookmark the 21st song (page 39).	You can bookmark up to 20 songs . Please bookmark within 20 songs.
AVLS	Since the AVLS setting is "AVLS ON", the volume can not be increased any more (page 66).	Set the AVLS setting to "AVLS OFF".
BLANK DISC	Contains an unrecorded disc.	---
BUSY	Processing the contents of recording or editing.	Wait for a while. In rare cases, it may take up to 1 minute .
CannotCHG	Attempted to charge at a temperature other than the specified temperature.	Charge within the specified temperature range.
Charging	Displayed during charging (page 18). — —	
DISC FULL	The remaining time of the disc is 12 seconds (24 seconds or 48 seconds) or less (during recording).	Replace with another recording disc.
ERROR	The internal system is malfunctioning.	Perform steps 1 to 3 in the table on page 81.
GroupFULL	I tried to create the 100th group. You can create up to 99 groups.	99 pieces Please make a group within.
Hi DC in	High power supply voltage (not using the specified AC power adapter or car battery cord).	Use the specified AC power adapter or car battery cord.
Hi-MD Disc	Hi-MD formatted current recording cannot be played on this unit. Contains an optical disc.	
HOLD	The hold function is working.	Turn the HOLD switch on the main unit in the opposite direction of the arrow to cancel the hold function (pages 14 and 19).
LINK OUT	With the i / LINK OUT output ("AUDIO OUT") set to "LINK OUT", you pressed VOL +, - . The battery is exhausted.	Set the i / LINK OUT output ("AUDIO OUT") to "Head Phone" (page 45). Recharge the rechargeable battery or
LOW BATT		replace it with a new battery (pages 18 and 19).
MEM OVER	I started recording where there was vibration. Record in a place without vibration. Operate with	
MENU	the remote controller while selecting a menu on the main unit. I pressed one of the	
	You pressed any of the keys on the main unit while selecting a menu on the remote control.	Operate with the remote control.
NAME FULL	200 sentences for song name, group name, and disc name I tried to enter the disc name, group name, and song name beyond the short letters. Enter the combination of letters and numbers to enter the songs of about 1700 characters in total .	(pages 51 and 52). And to enter the songs

display	meaning	measures
NO COPY	Dubbing is prohibited by the Serial Copy Management System (SCMS).	Record using analog input (LINE IN) (page 36).
NO DISC	There is no disc in it.	Insert the disc.
NO EDIT	<p>On an ungrouped disc, select " : Erase" from the menu (page 59). I tried to combine songs with different recording modes into one (page 57). An attempt was made to overwrite a track mark on top of it (page 56). During recording, the menu " : Set",</p> <p> Erase " : Release", "Move", and "Erase" .</p>	<p>You cannot delete a group on a disk that has not been set as a group.</p> <p>--</p>
No Entry!	An attempt was made to delete a personal disk on a disk that does not have personal disk memory registered.	--
No MARK	An attempt was made to play a bookmark (" TrPLAY") on an unbookmarked disc.	Add a bookmark (page 38) before operating. Operate with a disk with bookmarks.
NO SET	<p>An attempt was made to set the digital pitch control while setting the i / LINK OUT output ("AUDIO OUT") .</p> <p>I tried to do the following during recording.</p> <ul style="list-style-type: none"> • An attempt was made to set the personal disk memory (page 69). • You tried to set the melody timer (pages 68 and 69). • An attempt was made to set the digital pitch control (pages 44 and 45). • You tried to set the recording mode (page 30). • You tried to set the recording level (page 31). • Select " : REC" from the menu (page 34). • Select "REC Posi" from the menu during group recording (page 64). <p></p>	<p>Set the i / LINK OUT output ("AUDIO OUT") to "Head Phone" before operating.</p> <p>--</p>
NoOPERATE	<p>I tried to skip the group by pressing  + and - while setting the program on the remote control (page 39). Pressed the X button or T MARK button during synchronized recording . An attempt was made to set the auto time mark during synchronized recording (page 32).</p>	--

display	meaning	
NO SIGNAL	The digital input signal is interrupted.	Countermeasure Check the connection of the optical digital input. Ignore when inputting analog (LINE IN).
P / B ONLY	Contains a play-only disc.	Replace with a recording disc.
The PROTECTED disk is in the erasure prevention state (page 73).		Return the accidental erasure prevention knob.
Push STOP	When "TOC Edit" is displayed with the USB cable connected, you pressed one of the buttons.	--
The information on the READ ERR disk could not be read correctly.		Reinsert the disc.
	Contains a Hi-MD standard dedicated disc.	It cannot be played on this unit.
REC ERR	I couldn't record correctly.	Install this unit in a place where there is no vibration, and repeat the recording.
	The disc is heavily soiled (oil film, finger marks, etc.) or scratched, or the disc is out of specification.	Replace the disc and try recording again.
Rehearsal	During the divide rehearsal, I operated a remote controller other than the rotary knob.	--
SEL Group " : Name", with a song that is not in the group selected while it is stopped  playing .	I  erase " : Move" and  Erase".	With the song in the group you want to edit selected, operate it again.
SEL Track	When playback is finished, or with the song you want to END edit selected, press the SEARCH button again, and then the unit will stop and operate once. " : Name" in the stopped state ,  I  erase " : Move" and "  Erase".	
SLOW CHG	Trying to charge in a low temperature <small>slow batt</small>	Charge the battery in a place between + 5 ° C and + 40 ° C.
TEMP OVER	The temperature of this unit has become too high.	Let the unit rest for a while in a cool place before using it.
TOC Edit	The recorded information (start / end position of the song, etc.) is recorded on the disc (page 87) .	Wait for a while (do not give a shock or disconnect the power source).
TOC ERR	The disc information could not be read correctly.	Try inserting another disc. If you want to delete all the contents of the disc, delete all the recorded contents (page 58). Delete the song
TR FULL	The song number has exceeded 254.	number to 254 or less.
I tried to record / edit a song that has TrPROTECT track protection (preventing accidental erasure of the song).		Record and edit with other songs.
	I tried to record and edit a song transferred from my computer.	Transfer to a computer for editing.

Warranty and after-sales service

Warranty

card • This product comes with a warranty card, so please pick it up at the store of purchase.

- Please fill in the required items and check the contents, and save it in a safe place. • Warranty period is one year from the date of purchase

vinager.

After service

- If you are not feeling well, check first
Please read this manual again to find out. • If you still feel sick

Please contact the store where you purchased the product or your nearest Sony service counter in the attached "Sony Consultation Counter Information".

- Repairs during the warranty period will be repaired based on the contents of the warranty card. Please see the warranty for details. • Repairs after the warranty period will be charged if the function can be maintained by the repair.

- About the parts retention period
We have the repair performance parts (parts necessary to maintain the function of the product) of the portable minidisc recorder for 8 years after the production is discontinued. This parts holding period will be the repairable period. Even after the retention period has expired, repair may be possible depending on the location of the failure, so please contact the store where you purchased the product or the service center.

You can also do this

Here is some useful information to know when using a portable MD player.

I will explain briefly in Q & A format.

MD general

Q1: What is "TOC Edit"?

A1: TOC is an abbreviation for Table Of Contents, which is a territory on a minidisc that records information other than audio.

It is a

region. It records which song is what song and where it is on the disc. If a minidisc is a book, it is an index or table of contents. When recording, recording / deleting track marks, moving songs, etc., the MiniDisc recorder will rewrite the TOC ("TOC Edit" will be displayed). During this time, recording is performed on an optical disc, so do not subject it to shocks or disconnect the power supply. Not only will the recording not be done correctly, but the contents of the disc may be lost.

Q2: What is the sampling rate?

A2: Sampling rate is a number that indicates how much digital signal a second of audio should be.

The

value. Generally, the higher the value, the higher the sound quality. Normally, dubbing using digital signals is not possible between devices with different sampling rates. A sampling rate converter makes this possible. The converter converts the digital signal to a digital signal for another sampling rate. This unit has this converter built-in. Signals with different sampling rates (BS tuner: 32kHz, DAT: 48kHz, etc.) that enter the optical digital input terminal are converted to the MD sampling rate (44.1kHz) by the converter and recorded.

Q3: What is DSP TYPE-S for ATRAC / ATRAC3 ?

A3: Uses DSP TYPE-S for ATRAC installed in Sony's high-spec MD decks. You can enjoy high-quality sound when playing back in MDLP mode, which is attractive for long -time stereo recording. In addition, this DSP inherits the computing power of DSP TYPE-R for ATRAC, so it is also excellent for recording and playback in standard recording mode.

Q4: What is Net MD?

A4: With a standard that allows you to record music data stored in your computer to an MD via a USB cable.

vinegar. Since the only types of sound sources that can be recorded by conventional MDs are analog sound sources from microphones and analog inputs, or PCM sound sources from music CDs, recording from a personal computer was not possible. However, using music management software (SonicStage, etc.) based on copyright protection technology called "OpenMG" 1) and "MagicGate" 2), it is converted to the music data format "ATRAC" 3), "ATRAC3" 3). By doing so, it became possible to record to MD.

1) Copyright technology for managing music data such as CDs imported into a personal computer 2)

Technology for certifying whether a personal computer and a Net MD device support copyright protection 3) Conventional technology Format converted when recording MD

MD

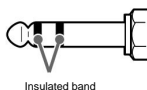
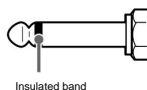

Tsu
Gain

Q5: How to distinguish between a stereo plug and a monaural plug?**A5:**Stereo plug: 2
bands of insulationMonaural plug: 1
band of insulation

recording

Q1: What can be recorded on MD?**A1:** Both analog input and digital input can be recorded. This unit has analog input and digital

Use the LINE IN (OPT) jack for input.

Analog input: •

Recording from a

microphone • Recording by connecting a connection cord (TV, radio, cassette, CD, MD, radio cassette player, stereo controller)

Recording from a port, amplifier, analog player, etc.)

Equipment with a stereo mini output jack such as a CD player, radio cassette player, or TV, or equipment with a headphone jack if there is no stereo mini output jack

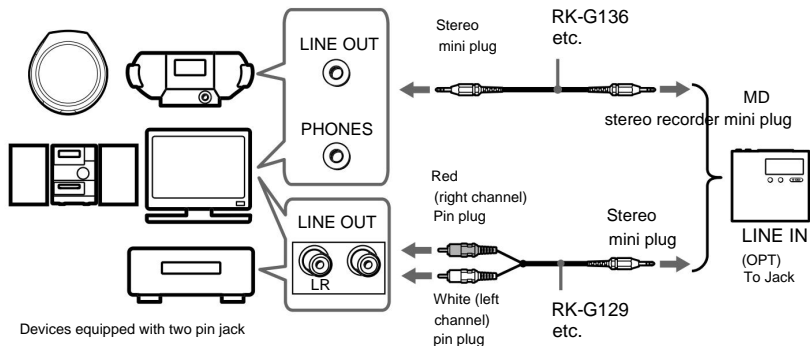

Devices equipped with two pin jack output jacks such as stereo amplifiers, mini stereo components, and TVs

Digital input: •

Recording by connecting an optical digital cable (CD, MD, DAT, DVD, BS, CS broadcasting, etc.)

When recording, check the shape of the audio output terminal of the recording source, and use an appropriate connection cord and optical digital cable.

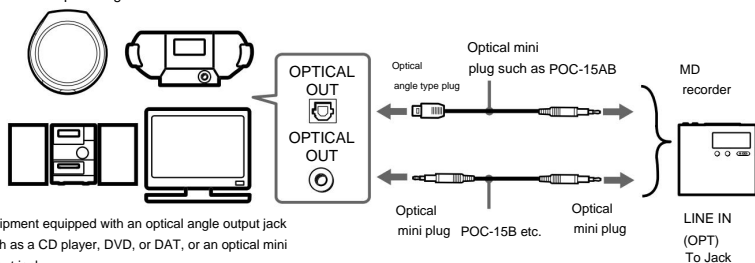

Equipment equipped with an optical angle output jack such as a CD player, DVD, or DAT, or an optical mini output jack

• Recording from a personal computer using Net MD

	Recording source output terminal	shape	Cable to use 1)
Analog Power	TV, radio, cassette, CD, MD, radio cassette player, stereo component, amp, etc.	LINE OUT AUX OUT REC OUT etc.	Pinjack Pin plug y stereo mini plug (RK-G129, etc.)
		Stereo Mini Jack 	Stereo mini plug y Stereo mini plug (RK-G136 etc.)
		HEADPHONES Phones i etc. 2)	Stereo mini plug y Stereo mini plug (RK-G136 etc.)
	Mike 4)	---	Microphone: Stereo mini plug (ECM-717, etc.)
Digital input	CD, MD, DAT, DVD, BS, CS broadcasting, etc.	OPTICAL OUT DIGITAL OUT etc. 5)	Light angle jack Optical angle type plug y Optical mini plug (POC-15AB, etc.)
		Optical mini jack 	Optical mini plug y Optical mini plug (POC-15B, etc.)
	PC 6)	USB 	Dedicated USB cable (included with Net MD device)

1) See page 74 for details. 2) Adjust the recording level. See page 31 for details. 3) If the hole diameter of the headphone jack is thicker than 3.5 mm (hole diameter 6.3 mm), use the plug adapter PC-234S or PC 234HS.

4) See page 33 for more information on recording with a microphone. 5) Recording is not possible from the coaxial (COAXIAL) output terminal.

6) Recording is possible only with Net MD compatible devices.

Q2: What is the difference between digital recording and analog recording?

A2: The following differences are made between digital recording (optical digital input) and analog recording (analog input).
I have.

	Input type Optical digital input	Analog input (LINE IN)
Difference		
Equipment that can be connected	Equipment with an optical digital output jack (CD player, DVD player, CD radio cassette player, etc.)	Equipment with an output (LINE OUT) jack (cassette deck, record player, etc.)
Code to use	Optical digital cable (connect a square plug or mini plug to the recording source device) (page 21)	Connection cord (connect a pin plug or stereo mini plug to the recording source device) (page 36)
Signal sent from the recording source	Digital signal	Even if a digital signal such as an analog signal CD is used as the recording source, it is sent to this unit as an analog signal.
How to attach the cue mark (song number) 1)	<ul style="list-style-type: none"> • If the sound source is a CD or MD, it will automatically connect to the same location as the recording source. • If the sound source is other than CD or MD Place a place where there is no sound (page 92) or a small sound for 2 seconds or more. • Automatically turns on when recording is paused (when silence continues for 3 seconds or longer during synchronized recording). 	
Loudness of recorded sound	Same as the original recording. It can also be adjusted manually (Digital REC level control) ("Adjusting the recording level manually" on page 31).	It is automatically adjusted. You can also adjust it manually ("Adjusting the recording level manually" on page 31).

1) If an unnecessary mark is added, erase it after recording ("Unify songs (combine)" on page 57).

please note

In the following cases, the cue mark (song number) may not be recorded at the same position as the recording source. • When recording with optical digital input from some CD players or multi-disc players • When recording with optical digital input using CD or MD software as a program performance (in such cases)

To record on a disc, set the recording source to the normal playback state.) • When recording BS and CS broadcast programs with optical digital input

Q3: When recording, how do I always start recording from behind the recorded part?

A3: Select "From End" in the recording start position ("REC-Posi") setting. For details on how to set the recording start position, see "Recording without overwriting" (page 64).

Q4: Is it possible to record from a device that does not have an optical digital output jack?

A4: Digital recording is not possible, but analog recording is possible if you use an analog output jack (LINE OUT / AUX OUT / REC OUT / CD OUT jack, headphone jack, etc.). When recording from the headphone jack, the sound volume of the connected device so that the sound is not distorted (when the loudest sound is input, the fifth bar from the left of the recording level display lights up). Please adjust. For details on how to adjust the recording level, see "Adjusting the recording level manually" (page 31).

**Q5: Is it possible to record a digitally recorded MD to another MD?**

A5: Minidiscs recorded from commercially available software such as CDs and playback-only MDs using the optical digital input terminal cannot be digitally recorded with other devices. This unit complies with the "Serial Copy Management System (SCMS)" to protect the copyright of music software. To record a minidisc recorded with optical digital input to another minidisc, use analog input (LINE IN).

Commercial software such as CDs or playback-only MDs

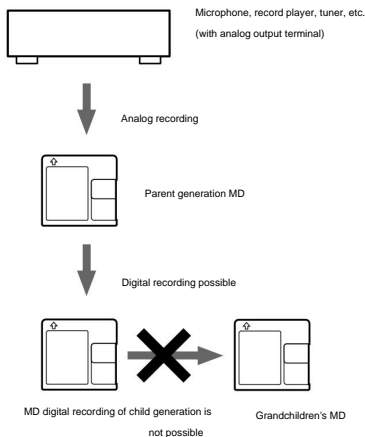
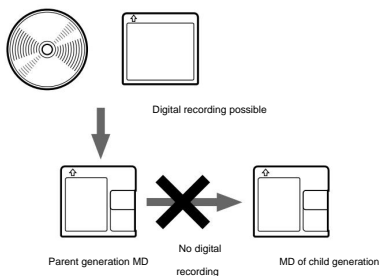

please note

Removing, modifying and modifying copy control signals to protect copyright is prohibited by law, even for personal enjoyment.

Q6: How do you get the MD song number?

A6: When recording from a medium with a song number such as a CD, the recorder will set the song number under the following conditions.

I will put it

on. Recording from digital input → Attach to the same place as the recording source CD. Recording from analog input → Silence continues for 2 seconds or more, and then when voice comes in. If a new song number starts from "0:03" on the CD, the new song number will be added to the MD at 0:00.

Q7: What is silence level?

A7: With this unit, the input level is approximately 4.8 mV (excluding Manual REC) for analog input, and approximately -89 dB or less for optical digital input when the full bit is 0 dB.

Q8: Why does the "TR FULL" display appear and recording stops even though I have plenty of time to record and the number of songs?

A8: This is a system constraint. If

you repeat recording and erasing on the same disc, the data of one song may not be recorded continuously, and it may be recorded separately in an empty space. Even in such a case, the minidisc quickly finds distant data and plays it in order. However, each divided data is treated the same as a song break (1 song), and when the total number of data reaches 254, it cannot be recorded. To add more songs, erase unnecessary songs and record.

reproduction

Q1: How can I play the MD Walkman sound by connecting it to a stereo component, radio cassette player, amplifier, etc.?

A1: MD Walkman's i / LINK OUT jack and LINE IN / AUX for radio cassette recorders and amplifiers.

Connect to an input jack such as IN / REC IN and operate on the MD Walkman side.

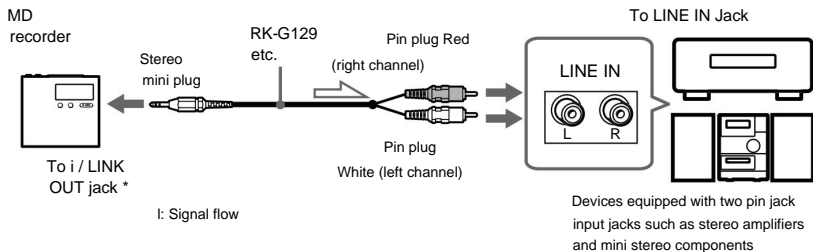

* Set the i / LINK OUT output to "LINK OUT". See page 45 for details.

Q2: When I fast-forward and fast-rewind while playing the edited song, the sound is interrupted. why?

A2: It is a system constraint.

When fast-forwarding and fast-rewinding while playing, it plays faster than usual, so if short songs are scattered in various places on the disc, it may take a long time to find and the sound may be interrupted. ..

edit

Q1: Why can't the track mark (song number) be erased?

A1: In the following cases, the track mark cannot be erased due to system restrictions.

- The data of the songs to be connected are distributed on the disc, and the length of each data is short (12 seconds or less for stereo recording, 24 seconds or less for LP2 / monaural recording, or 48 seconds or more for LP4 recording). In the case of (below), it may not be possible to erase the beginning mark (song number) of the song and connect it to the previous song.
- Remove cue marks between songs recorded in different recording modes (eg LP2 and LP4) I can't.

Q2: Why doesn't the remaining time that can be recorded on the disc increase even if the song is erased?

A2: It is a system constraint. When

displaying the remaining recordable time of a disc, the part of 12 seconds or less (during stereo recording), 24 seconds or less (during LP2 stereo recording, monaural recording), or 48 seconds or less (during LP4 stereo recording) is ignored. Therefore, no matter how many short songs are erased, the remaining time that can be recorded may not increase.

Q3: Why does the total recording time and remaining time on the disc not match the maximum recordable time (60 minutes, 74 minutes, 80 minutes)?

A3: It is a system constraint. Normally,

recording is about 2 seconds during stereo recording, about 4 seconds during LP2 stereo recording or monaural recording, Record on an optical disc with a minimum unit of approximately 8 seconds during LP4 stereo recording. Where you stop recording, use about 2 seconds (4 or 8 seconds) of space, even if the last part of the recording is actually less than 2 seconds (4 or 8 seconds). Also, when you stop recording and then start recording again, leave a space of about 2 seconds (4 seconds or 8 seconds) at the beginning of recording to start recording. This is to avoid accidentally erasing the previous song when you start recording. Therefore, the actual recordable time is up to 6 seconds (12 seconds or 24 seconds) shorter than the maximum recordable time each time recording is stopped.

Group function

Q1: How to "group setting"?

A1: There are four ways. See the reference page for detailed instructions.

Before

recording • Set "REC" in the menu to "REC ON". ("When recording, always glue Record as a recording" (page 34))

When recording • Create a new group and record

If you press the END SEARCH button while stopped to start recording, a new group will be created and recorded in that group. ("Create a new group and record" (page 34))

- Record a new song in an existing group

Select a group before recording. ("Recording to an existing group" (page 35)) After recording • Set the recorded disc as a group.

Select the first and last songs you want to group and set the group. ("Combining songs and groups into one group (group setting)" (page 47))

Q2: How to combine separated songs and groups into one?

A2: In advance, set the group settings after connecting the songs and groups you want to put together next to each other. is. For details, see "Changing the song order (move)" (page 53) and "Rearranging the order of groups (group move)" (page 54).

Q3: How is the group name recorded?

A3: When recording using the group function, the group information is automatically recorded in the recording area of the disc name as the "disc name". Specifically, the following character string is written.

Recording area of disc name

Example)

0;Favorites//2-4;Rock//6-9;Pops//

one two three

1 Disc name: "Favorites" Group

name from 22nd to 4th song: "Rock" Group name

from 36th to 9th song: "Pops"

If the MD set as a group is read by a device that does not support the group function, the above character string will be displayed as the "disk name" as it is. Normally, this character string is not displayed on this unit, but if you press the GROUP button (+ or - button on the remote control) for 2 seconds or longer while editing the disk name, this character string can be displayed. You can edit the group name directly.

Q4: The new group is not recorded, why can't I set a new group ? why?

A4: It may be because the total number of input characters on the entire disk has exceeded the limit (system control).

about).

As shown in A3, group information is done using the disk name area. The disc name and song name are recorded in the same area, and the maximum number of characters is approximately 1700 characters in total for the disc name (including group information) and song name. If this number of characters is exceeded, no new group will be created when recording in group mode. Also, when I try to set a group, I cannot.

index

A line

Erase 58 , 59 Care
73 Auto Time Mark 32

Ka line

Confirmation
sound 63 Kanji
display 67 Erase
songs 58 , 59 Connect
songs 57 Divide songs
56 Quick mode 64
Move group 53-55
Cancel 49 Erase 58 ,
59 Play 39 , 40 Skip
39 Settings 47 , 48
Recording 34 , 35
Contrast 67 Combine
57

Sa line

Playback mode 38-41
Sampling rate 87 Centralized
control key 14 Charging 18
Charging stand 13 , 18
Bookmark 38 Jog dial 63
connection Analog connection
36 Charging 18 , 20 Digital
connection 21

Line

Copyright 91
Digital Pitch Control 44 , 45 Battery Dry
Battery 19 Rechargeable Battery 18
Duration 20 Divide 56

Divide rehearsal 56 Clock
adjustment 62 Track mark
erase 57 Automatically turn
on (recording) 32 Manually
turn on (recording) 32 Turn on
56

Line

Give a name 49-51
Change a name 51 , 52
Name 49-52

Is a line

Backlight 66 Personal
Disc Memory 69 Virtual Surround 41 ,
43 Display 29 , 37 Accessories 13
Bookmark 38 , 40 Program Playback
39 , 41 Optional Accessories 74 Hold
14 , 16 , 19

Ma

silence level
92 menu 27 , 28
melody timer 68 , 69

Line

Recording Analog 36 ,
88 Setting the start
position 64 Synchro
recording 35 Long-time
recording 30 Digital
21 , 88 Microphone 33
Level 31

Alphabet / numbers

AVLS 66
DSP TYPE-S 87
MDLP 30
Net MD 87
USB
dedicated cable 13 , 60, 61 6-
band equalizer 42 , 43

Inquiry window information

If you have any questions about this machine, have technical questions, or have any questions about problems, please use the contact information below.

- To find out on the homepage, go to **k** Personal Audio Customer Support.

(<http://www.sony.co.jp/support-pa/>)

We provide the latest support information about this machine, as well as frequently asked questions and answers.

- For inquiries by phone or fax, contact the **Customer Service Center** (see below).

• The product category of this unit is [Audio]-[Walkman]. • When making inquiries, please let us know the following. • When you have a question about the set body: •

Model name: • Serial number: Refer to the attached "Customer registration request" for the description position • Consultation content: As detailed as possible • Date of purchase • Questions related to the attached software When: • Software version: • Your computer (manufacturer name / model name) • OS name installed on your computer: • Memory capacity / free hard disk space: • CD-ROM drive model name / type (outside) Attached or built-in): • Error message (if an error message is displayed):

商品の修理、お取扱い方法、お買物相談などの問い合わせ

● <http://www.sony.co.jp/SonyDrive/>

お客様ご相談センター

● ナビダイヤル ☎ 0570-00-3311

(全国どこからでも市内通話料でご利用いただけます)

● 携帯電話・PHSでのご利用は... 03-5448-3311

(ナビダイヤルがご利用できない場合はこちらをご利用ください)

● FAX 0466-31-2595

受付時間 : 月~金 9:00~20:00 土・日・祝日 9:00~17:00

お電話は自動音声応答にてお受けしています。

ソニー株式会社 〒141-0001 東京都品川区北品川 6-7-35



この説明書は100%古紙再生紙とVOC
(揮発性有機化合物)ゼロ植物油型インキ
を使用しています。



* 32 6370504

* (1)